

Commission File: 9642418

February 12, 2016

Prince Rupert Gas Transmission Ltd.
450-1st Street SW
Calgary, Alberta
T2P 5H1

Attention: Prince Rupert Gas Transmission Ltd.

Re: Correction of Road Permit located at Seg. 1 from a-54-H, 93-M-5 to d-54-H, 93-M-5

The BC Oil and Gas Commission, under section 78(2)(b) of *Oil and Gas Activities Act*, hereby corrects the Permit and Authorizations Associated with the Permit containing 0.62 hectares, as shown on sketch plan, Job: 3111-22807, Document No: 161.0.1.3_OGC_20k, revision 0, dated April 30, 2015 by McElhanney Geomatics Professional Land Surveying Ltd., as follows:

- Replace permission 1(a) with: The authorization granted under this permit is limited to the area described in ePASS 10052186 as submitted to the Commission in the transition application dated May 11, 2015.
- The addition of the following conditions:
 11. Within 45 days of this approval, the permit holder must submit a revised ePASS 10052186 to reflect the change in road right of way width.
 12. Prior to commencement of any ground disturbing activities, the permit holder must have an archaeological overview assessment completed by a qualified professional and complete any applicable archaeological impact assessments, based on the recommendations of the qualified professional.
 13. The permit holder must restrict all activities to the previously cleared road right of way. Where new cut is required, the permit holder must submit an amendment application to request authorization to clear new area.
 14. A notice of construction start must be submitted to the Commission a minimum of 72 hours prior to the construction of activities under this permit. Notification must be sent to OGC.ExternalNotifications@bcogc.ca.

The permit holder must comply with all conditions in the original permission and any additional conditions as noted above.

This letter forms an integral part of the Permit and should be attached thereto.

A handwritten signature in black ink, appearing to read 'B. Murphy', with a stylized flourish at the end.

Brian Murphy
Executive Director, Major Projects
Commission Delegated Decision Maker

cc: Roy Northern Land Service Ltd.
OGC File: 9642418
OGC First Nations LXDJ



December 11, 2015

Prince Rupert Gas Transmission Ltd.
450 - 1st Street SW
Calgary, AB T2P 5H1

Attention: Prince Rupert Gas Transmission Ltd.

RE: Road Permit

Date of Issuance: December 11, 2015

Transition of Non-Status Roads to OGAA Road Permit under the implementation of OGRR.

Commission No.: 9642418

Road Permit No.: 03291

Road Name: PRGT Pinenut Spur 3291

PERMISSIONS

1. The BC Oil and Gas Commission ("the Commission"), under section 25 (1) of the *Oil and Gas Activities Act* hereby permits the holder to construct and maintain an oil and gas road, subject to the following conditions:
 - a. The authorization granted under this permit is limited to the area described in sketch plan; Job: 3111-22807, Document No.: 161.0.1.3_OGC_20k, REVISION 0, dated April 30, 2015 completed by McElhanney Geomatics Professional Land Surveying Ltd. as submitted to the Commission in the transition application dated May 11, 2015.
 - b. Permission to construct is limited to required modifications within the operating area except as otherwise restricted by this permit.
 - c. Pursuant to Section 138(1) of the *Petroleum and Natural Gas Act*, the permit holder is permitted to enter, occupy and use any unoccupied Crown land located within the operating area to carry out the oil and gas activities authorized under this permit.
 - d. The permission to occupy and use Crown land expires if this permit expires, or is suspended, cancelled, surrendered or declared spent.

CONDITIONS

1. The permit holder must submit the post-construction plan, as per section 11 of the Oil and Gas Road Regulation, as an ePASS shape file and PDF plan accurately identifying the location of the total area actually disturbed under this permit.
2. The permit holder will immediately effect, and keep in force while occupying the site, insurance of an amount not less than \$1,000,000 protecting the Province, the Commission and the permit holder (without any rights of cross-claim or subrogation) against claims for personal injury, death, property damage, or third party liability claims arising from any accident or occurrence on the site.
3. The permission to occupy and use Crown land does not entitle the permit holder to exclusive possession of the area.
4. The rights granted by this permission are subject to all subsisting grants to or rights of any person made or acquired under the *Coal Act, Forest Act, Land Act, Mineral Tenure Act, Petroleum and Natural Gas Act, Range Act, Water Act* or *Wildlife Act*, or any extension or renewal of the same.

5. The permit holder must not assign, sublicense or transfer this permit or permit any person to use or occupy the land, other than its employees, contractors, or representatives, without the Commission's written consent.
6. The permit holder must ensure that the area is maintained in a condition so as to minimize hazards, including but not limited to hazards associated with storage of materials and equipment.
7. The permit holder must ensure that the area is free of garbage, debris and unused equipment.
8. Following initial construction, stream crossings are authorized for necessary road modification or maintenance activities on the operating area except for
 - a. construction or replacement of a bridge or major culvert on a S1, S2, S3 or S5 stream;
 - b. installation of a closed bottom structure in a fish bearing stream; or
 - c. excavation or grading of a stream bank or stream bed.
9. Stream crossings must be constructed, maintained and deactivated according to the following requirements, as applicable:
 - a. only bridges, culverts, ice bridges or snow fills may be constructed at stream crossings;
 - b. snow fills must consist of clean snow and may only be located on streams that are dry or frozen to the bottom during the period of construction, maintenance and use. Where periodic thaws are anticipated, culverts must be installed to allow meltwater to pass through. Snow fill and any installed culverts must be removed prior to spring snow melt;
 - c. ice bridges on fish bearing streams may only be constructed where sufficient water depth and stream flows prevent the bridge structure from coming in contact with the stream bottom;
 - d. water applied to construct an ice bridge on a water body must be sourced in accordance with the *Water Act* unless
 - i. the water body is a stream with a stream channel width of at least 5 metres and is not designated as a sensitive stream under the *Fish Protection Act*, or has a riparian class of W1, W3, or L1,
 - ii. the water is sourced from the same water body proximal to the location on which the ice bridge is constructed,
 - iii. the water body is not within the boundaries of a public park,
 - iv. pump intakes do not disturb beds of streams or wetlands and are screened with a maximum mesh size and approach velocity in accordance with the Fisheries and Oceans Canada Freshwater Intake End-of-Pipe Fish Screen Guideline, and
 - (a) where the water body is a stream, the flow of water in the stream at the time and location of pumping exceeds 60 litres per second and the instantaneous pumping rate does not exceed 1% of the water flowing in the water body at the time and location the pumping occurs, or
 - (b) where the water body is a lake or pond, the cumulative volume of water withdrawn does not exceed 10 cm of lake or pond depth, calculated as the product of lake or pond surface area x 10 cm;
 - e. records of water withdrawal and corresponding streamflow measurements are maintained by the permit holder and provided to the Commission upon request;
 - f. in-stream activities within a fish bearing stream, lake or wetland must occur:
 - i. during the applicable reduced risk work windows as specified in the Skeena Region Reduced Risk In-stream Work Windows and Measures, May 2005,
 - ii. in accordance with alternative timing and associated mitigation recommended by a qualified professional and accepted by the Commission, or
 - iii. in accordance with an authorization or letter of advice from Fisheries and Oceans Canada that is provided to the Commission;
 - g. bridge or culvert abutments, footings and scour protection must be located outside the natural stream channel and must not constrict the channel width;
 - h. equipment used for activities under this authorization must not be situated in a stream channel unless it is dry or frozen to the bottom at the time of the activity.

10. The permit holder must notify the Wilp Gutgwinuxs(Lax Xsin Djihl) a minimum of five (5) days prior to commencing initial use of road.

ADVISORY GUIDANCE

1. The permit holder must construct, maintain and deactivate the road in accordance with the Oil and Gas Road Regulation.
2. The permit holder must not close or restrict the use of the road except as provided for in the Oil and Gas Road Regulation.

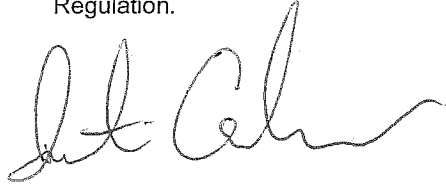

Justin Anderson
Authorized Signatory
Commission Delegated Decision Maker

pc: Roy Northern Land Service Ltd.
Commission File: 9642418
OGC First Nations: LXDJ

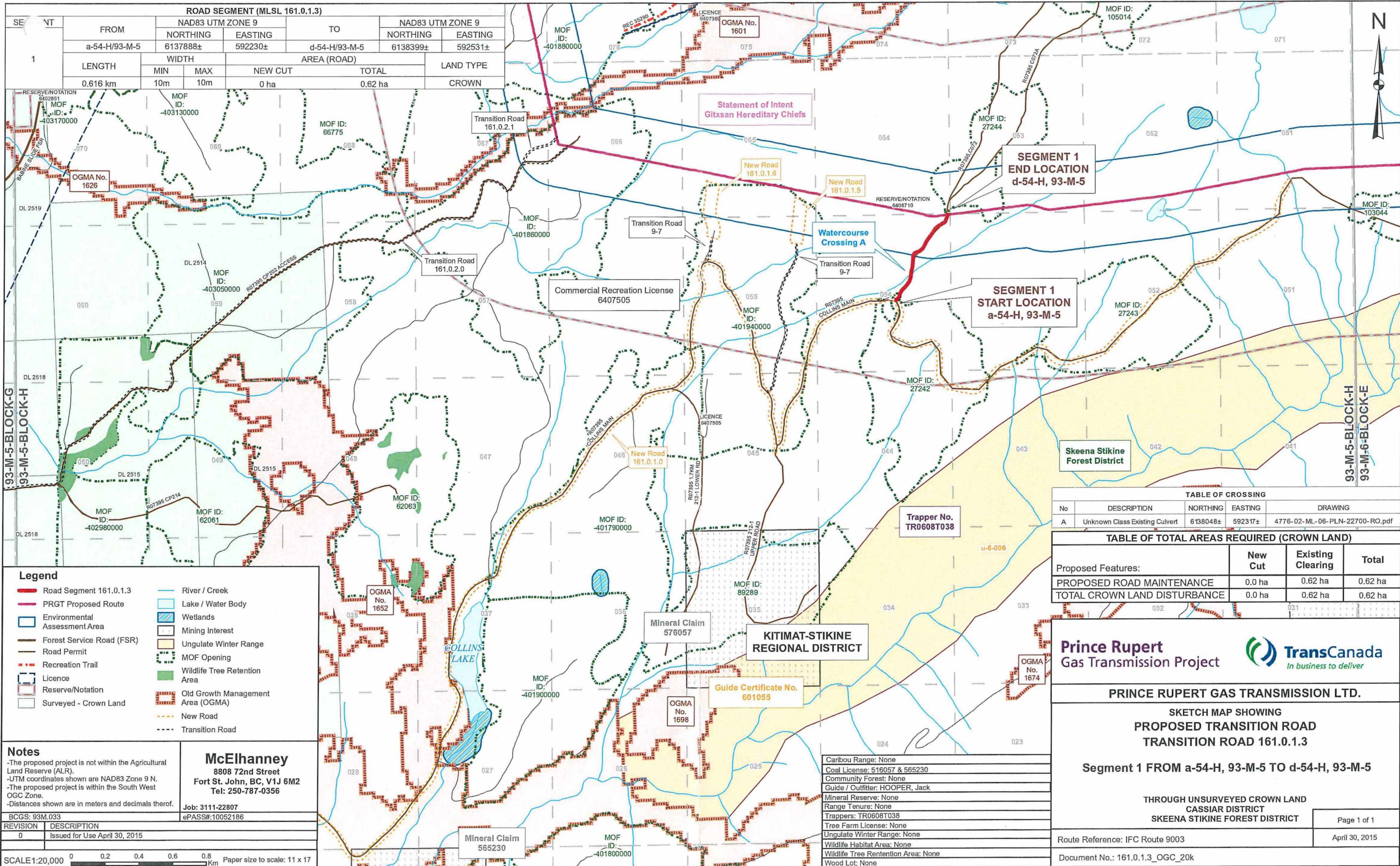

ROAD SEGMENT (MLSL 161.0.1.3)						
SECT	FROM	NAD83 UTM ZONE 9		TO	NAD83 UTM ZONE 9	
		NORTHING	EASTING		NORTHING	EASTING
1	a-54-H/93-M-5	6137888±	592230±	d-54-H/93-M-5	6138399±	592531±
LENGTH	WIDTH		AREA (ROAD)		LAND TYPE	
	MIN	MAX	NEW CUT	TOTAL		
0.616 km	10m	10m	0 ha	0.62 ha	CROWN	

Legend	
	Road Segment 161.0.1.3
	PRGT Proposed Route
	Environmental Assessment Area
	Forest Service Road (FSR)
	Road Permit
	Recreation Trail
	Licence
	Reserve/Notation
	Surveyed - Crown Land
	River / Creek
	Lake / Water Body
	Wetlands
	Mining Interest
	Ungulate Winter Range
	MOF Opening
	Wildlife Tree Retention Area
	Old Growth Management Area (OGMA)
	New Road
	Transition Road

Notes
 -The proposed project is not within the Agricultural Land Reserve (ALR).
 -UTM coordinates shown are NAD83 Zone 9 N.
 -The proposed project is within the South West OGC Zone.
 -Distances shown are in meters and decimals thereof.

McElhanney
 8808 72nd Street
 Fort St. John, BC, V1J 6M2
 Tel: 250-787-0356

Job: 3111-22807
 ePASS#:10052186

REVISION	DESCRIPTION
0	Issued for Use April 30, 2015

SCALE 1:20,000

Paper size to scale: 11 x 17

TABLE OF CROSSING				
No	DESCRIPTION	NORTHING	EASTING	DRAWING
A	Unknown Class Existing Culvert	6138048±	592317±	4776-02-ML-06-PLN-22700-RO.pdf

TABLE OF TOTAL AREAS REQUIRED (CROWN LAND)			
Proposed Features:	New Cut	Existing Clearing	Total
PROPOSED ROAD MAINTENANCE	0.0 ha	0.62 ha	0.62 ha
TOTAL CROWN LAND DISTURBANCE	0.0 ha	0.62 ha	0.62 ha

Prince Rupert Gas Transmission Project

TransCanada
In business to deliver

PRINCE RUPERT GAS TRANSMISSION LTD.

SKETCH MAP SHOWING
 PROPOSED TRANSITION ROAD
 TRANSITION ROAD 161.0.1.3

Segment 1 FROM a-54-H, 93-M-5 TO d-54-H, 93-M-5

THROUGH UNSURVEYED CROWN LAND
 CASSIAR DISTRICT
 SKEENA STIKINE FOREST DISTRICT

Page 1 of 1

Route Reference: IFC Route 9003
 April 30, 2015

Document No.: 161.0.1.3_OGC_20k

Caribou Range: None
Coal License: 516057 & 565230
Community Forest: None
Guide / Outfitter: HOOPER, Jack
Mineral Reserve: None
Range Tenure: None
Trappers: TR0608T038
Tree Farm License: None
Ungulate Winter Range: None
Wildlife Habitat Area: None
Wildlife Tree Retention Area: None
Wood Lot: None

9642418