

Commission File: 9642322

February 12, 2016

Prince Rupert Gas Transmission Ltd.
450-1st Street SW
Calgary, Alberta
T2P 5H1

Attention: Prince Rupert Gas Transmission Ltd.

Re: Correction of Road Permit located at Seg. 1 from a-17-K, 93-K-16 to b-16-K, 93-K-16

The BC Oil and Gas Commission, under section 78(2)(b) of *Oil and Gas Activities Act*, hereby corrects the Permit and Authorizations Associated with the Permit containing 0.31 hectares, as shown on sketch plan, Job: 3111-22807, Document No: 97.0.3.2_OGC_20k, revision 0, dated April 16, 2015 by McElhanney Geomatics Professional Land Surveying Ltd., as follows:

- Replace permission 1(a) with: The authorization granted under this permit is limited to the area described in ePASS 10052010 as submitted to the Commission in the transition application dated April 21, 2015.
- The addition of the following conditions:
 13. Within 45 days of this approval, the permit holder must submit a revised ePASS 10052010 to reflect the change in road right of way width.
 14. Prior to commencement of any ground disturbing activities, the permit holder must have an archaeological overview assessment completed by a qualified professional and complete any applicable archaeological impact assessments, based on the recommendations of the qualified professional.
 15. The permit holder must restrict all activities to the previously cleared road right of way. Where new cut is required, the permit holder must submit an amendment application to request authorization to clear new area.
 16. A notice of construction start must be submitted to the Commission a minimum of 72 hours prior to the construction of activities under this permit. Notification must be sent to OGC.ExternalNotifications@bcogc.ca.

The permit holder must comply with all conditions in the original permission and any additional conditions as noted above.

This letter forms an integral part of the Permit and should be attached thereto.

A handwritten signature in black ink, appearing to read 'B. Murphy', with a stylized flourish at the end.

Brian Murphy
Executive Director, Major Projects
Commission Delegated Decision Maker

cc: Roy Northern Land Service Ltd.
OGC File: 9642322
OGC First Nations CSTC, NAFN, TLAZ, YFN



November 27, 2015

Prince Rupert Gas Transmission Ltd.
450 - 1st Street SW
Calgary, AB T2P 2H1

Attention: Prince Rupert Gas Transmission Ltd.

RE: Road Permit

Date of Issuance: November 27, 2015

Transition of Non-Status Roads to OGAA Road Permit under the implementation of OGRR.

Commission No.: 9642322

Road Permit No.: 03272

Road Name: PRGT Kleedlee Road 3272

PERMISSIONS

1. The BC Oil and Gas Commission ("the Commission"), under section 25 (1) of the *Oil and Gas Activities Act* hereby permits the holder to construct and maintain an oil and gas road, subject to the following conditions:
 - a. The authorization granted under this permit is limited to the area described in sketch plan; Job: 3111-22807, Document No.: 97.0.3.2_OGC_20k, REVISION 0, dated April 16, 2015 completed by McElhanney Geomatics Professional Land Surveying Ltd. as submitted to the Commission in the transition application dated April 21, 2015.
 - b. Permission to construct is limited to required modifications within the operating area except as otherwise restricted by this permit.
 - c. Pursuant to Section 138(1) of the *Petroleum and Natural Gas Act*, the permit holder is permitted to enter, occupy and use any unoccupied Crown land located within the operating area to carry out the oil and gas activities authorized under this permit.
 - d. The permission to occupy and use Crown land expires if this permit expires, or is suspended, cancelled, surrendered or declared spent.

CONDITIONS

1. The permit holder must submit the post-construction plan, as per section 11 of the Oil and Gas Road Regulation, as an ePASS shape file and PDF plan accurately identifying the location of the total area actually disturbed under this permit.
2. The permit holder will immediately effect, and keep in force while occupying the site, insurance of an amount not less than \$1,000,000 protecting the Province, the Commission and the permit holder (without any rights of cross-claim or subrogation) against claims for personal injury, death, property damage, or third party liability claims arising from any accident or occurrence on the site.
3. The permission to occupy and use Crown land does not entitle the permit holder to exclusive possession of the area.
4. The rights granted by this permission are subject to all subsisting grants to or rights of any person made or acquired under the *Coal Act, Forest Act, Land Act, Mineral Tenure Act, Petroleum and Natural Gas Act, Range Act, Water Act* or *Wildlife Act*, or any extension or renewal of the same.

5. The permit holder must not assign, sublicense or transfer this permit or permit any person to use or occupy the land, other than its employees, contractors, or representatives, without the Commission's written consent.
6. The permit holder must ensure that the area is maintained in a condition so as to minimize hazards, including but not limited to hazards associated with storage of materials and equipment.
7. The permit holder must ensure that the area is free of garbage, debris and unused equipment.
8. Following initial construction, stream crossings are authorized for necessary road modification or maintenance activities on the operating area except for
 - a. construction or replacement of a bridge or major culvert on a S1, S2, S3 or S5 stream;
 - b. installation of a closed bottom structure in a fish bearing stream; or
 - c. excavation or grading of a stream bank or stream bed.
9. Stream crossings must be constructed, maintained and deactivated according to the following requirements, as applicable:
 - a. only bridges, culverts, ice bridges or snow fills may be constructed at stream crossings;
 - b. snow fills must consist of clean snow and may only be located on streams that are dry or frozen to the bottom during the period of construction, maintenance and use. Where periodic thaws are anticipated, culverts must be installed to allow meltwater to pass through. Snow fill and any installed culverts must be removed prior to spring snow melt;
 - c. ice bridges on fish bearing streams may only be constructed where sufficient water depth and stream flows prevent the bridge structure from coming in contact with the stream bottom;
 - d. water applied to construct an ice bridge on a water body must be sourced in accordance with the *Water Act* unless
 - i. the water body is a stream with a stream channel width of at least 5 metres and is not designated as a sensitive stream under the *Fish Protection Act*, or has a riparian class of W1, W3, or L1,
 - ii. the water is sourced from the same water body proximal to the location on which the ice bridge is constructed,
 - iii. the water body is not within the boundaries of a public park,
 - iv. pump intakes do not disturb beds of streams or wetlands and are screened with a maximum mesh size and approach velocity in accordance with the Fisheries and Oceans Canada Freshwater Intake End-of-Pipe Fish Screen Guideline, and
 - (a) where the water body is a stream, the flow of water in the stream at the time and location of pumping exceeds 60 litres per second and the instantaneous pumping rate does not exceed 1% of the water flowing in the water body at the time and location the pumping occurs, or
 - (b) where the water body is a lake or pond, the cumulative volume of water withdrawn does not exceed 10 cm of lake or pond depth, calculated as the product of lake or pond surface area x 10 cm;
 - e. records of water withdrawal and corresponding streamflow measurements are maintained by the permit holder and provided to the Commission upon request;
 - f. *in-stream activities within a fish bearing stream, lake or wetland must occur:*
 - i. during the applicable reduced risk work windows as specified in the Region 7 Omineca – Reduced Risk Timing Windows for Fish and Wildlife,
 - ii. in accordance with alternative timing and associated mitigation recommended by a qualified professional and accepted by the Commission, or
 - iii. in accordance with an authorization or letter of advice from Fisheries and Oceans Canada that is provided to the Commission;
 - g. bridge or culvert abutments, footings and scour protection must be located outside the natural stream channel and must not constrict the channel width;
 - h. equipment used for activities under this authorization must not be situated in a stream channel unless it is dry or frozen to the bottom at the time of the activity.

10. The permit holder must notify Nak'azdli First Nation a minimum of five (5) days prior to commencing any construction activities under this permit.
11. The permit holder must notify Takla Lake First Nation a minimum of five (5) days prior to commencing any construction activities under this permit.
12. The permit holder must notify Yekooche First Nation a minimum of five (5) days prior to commencing any construction activities under this permit.

ADVISORY GUIDANCE

1. The permit holder must construct, maintain and deactivate the road in accordance with the Oil and Gas Road Regulation.
2. The permit holder must not close or restrict the use of the road except as provided for in the Oil and Gas Road Regulation.



Johannes Bendle
Authorized Signatory
Commission Delegated Decision Maker

pc: Roy Northern Land Service Ltd.
Commission File: 9642322
OGC First Nations: CSTC, NAFN, TLFN, YFN

ROAD SEGMENT (MLSL 97.0.3.2)						
SEGMENT	FROM		NAD83 UTM ZONE 10		TO	
	NORTHING	EASTING	NORTHING	EASTING	NORTHING	EASTING
	a-17-K/93-K-16	6087535±	414876±	b-16-K/93-K-16	6087500±	415142±
LENGTH	WIDTH		AREA (ROAD)		TOTAL	LAND TYPE
	MIN	MAX	NEW CUT			
0.309 km	10m	10m	0.00 ha		0.31 ha	CROWN

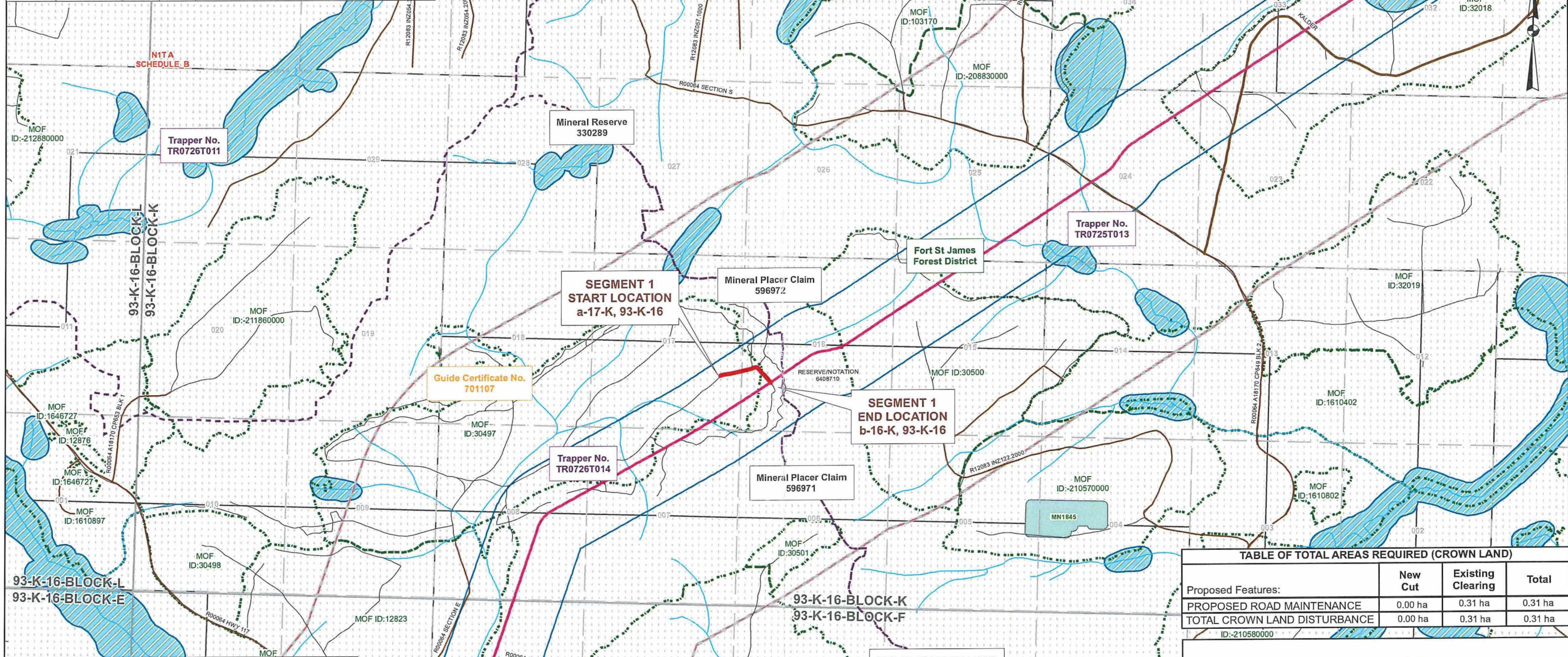

TABLE OF TOTAL AREAS REQUIRED (CROWN LAND)			
Proposed Features:	New Cut	Existing Clearing	Total
PROPOSED ROAD MAINTENANCE	0.00 ha	0.31 ha	0.31 ha
TOTAL CROWN LAND DISTURBANCE	0.00 ha	0.31 ha	0.31 ha

Legend

- Road Segment 97.0.3.2 (Red line)
- PRGT Proposed Route (Pink line)
- Environmental Assessment Area (Blue hatched area)
- Reserve/Notation (Dashed line)
- Wetlands (Blue area)
- River / Creek (Blue line)
- Trapper Boundary (Dashed line)
- Guide Boundary (Dotted line)
- Mining Interest (Yellow hatched area)
- Forestry Map Notation (Green hatched area)
- Road / Trail (Black line)

Notes

- The proposed project is not within the Agricultural Land Reserve (ALR).
- UTM coordinates shown are NAD83 Zone 10 N.
- The proposed project is within the South West OGC Zone.
- Distances shown are in meters and decimals thereof.

McElhanney
 8808 72nd Street
 Fort St. John, BC, V1J 6M2
 Tel: 250-787-0356

Job: 3111-22807
 ePASS #: 10052010

REVISION	DESCRIPTION
0	Issued for Use April 16, 2015

SCALE 1:20,000

Caribou Range: None
Coal License: None
Community Forest: None
Guide / Outfitter: TREPUS, Paul
Mineral Reserve: 330289
Mineral Placer Claims: 596971 & 596972
Coal Reserve: None
Range Tenure: None
Trappers: TR0726T014
Tree Farm License: None
Ungulate Winter Range: None
Wildlife Habitat Area: None
Wildlife Tree Retention Area: None
Wood Lot: None

Prince Rupert Gas Transmission Project 

PRINCE RUPERT GAS TRANSMISSION LTD.

SKETCH MAP SHOWING
 PROPOSED TRANSITION ROADS
 TRANSITION ROAD 97.0.3.2

Segment 1 FROM a-17-K, 93-K-16 TO b-16-K, 93-K-16

THROUGH UNSURVEYED CROWN LAND
 RANGE 5 COAST DISTRICT
 FORT ST. JAMES FOREST DISTRICT

Route Reference: IFC Route 9003
 Document No.: 97.0.3.2_OGC_20k

Page 1 of 1
 April 16, 2015

9642322