

September 17, 2015

Prince Rupert Gas Transmission Ltd.
450- 1st Street
Calgary, Alberta T2P 5H1

Attention: Surface Land Administrator

RE: Road Permit

Road Location: From NTS: c-94-H/93-O-16 To NTS: a-14-H/93-O-16

From: UTM Zone 10 Northing 6197122 Easting 559303; To: UTM Zone 10 Northing 6198346 Easting 559697

Date of Issuance: September 17, 2015

Road No.: 03199

Road Name: PRGT Johnson Creek (CS-2) Access Road

OGC File No: 9641911

PERMISSIONS

1. The BC Oil and Gas Commission ("the Commission"), under section 25 (1) of the *Oil and Gas Activities Act* hereby permits the holder to construct, operate and maintain an oil and gas road, subject to the following conditions:
 - a. The authorization granted under this Permit is limited to the area described in survey plan number: WSP File: 130402SK17R4, revision 4, dated May 29, 2015, completed by WSP Surveys (BC) Limited Partnership, as submitted to the Commission in the Permit application dated February 5, 2015. This includes all ancillary activities as shown on the construction plan.
 - b. The Permit holder is authorized to occupy and use Crown land under Section 138(1) of the *Petroleum and Natural Gas Act* for the area as described in the above noted survey plan for the purposes of constructing, maintaining and operating an oil and gas road and for the construction of the ancillary activities.
 - c. The Permit holder will construct and install all bridges and culverts in accordance with section 6 of the Oil and Gas Road Regulation (OGRR). An exemption may be granted, if section 6 (1)(a) cannot be adhered to.
 - d. The permission to construct an oil and gas road is deemed spent upon the submission of the report describing the location of the constructed road (section 11 OGRR). Any future modifications to the oil and gas road will require an amendment. The permission to maintain the oil and gas road remains in good standing.

CONDITIONS

1. If artifacts, features, materials or things protected under section 13(2) of the Heritage Conservation Act are identified the permit holder must, unless the permit holder holds a permit under section 12 of the Heritage Conservation Act issued by the Commission in respect of that artifact, feature, material or thing:
 - a. immediately cease all work in the vicinity of the artifacts, features, materials or things;
 - b. immediately notify the Commission and the Archaeology Branch of the Ministry of Forests, Lands and Natural Resource Operations
 - c. refrain from resuming work in the vicinity of the artifacts, features, materials or things except in accordance with an appropriate mitigation plan that has been prepared in accordance with the Heritage Conservation Act and approved by the Commission

2. The ancillary activities associated with the Road Permit are only authorized for their initial construction and use; and will be deemed spent upon the submission of the post-construction plan.
3. The Permit holder must restore all areas disturbed with the construction of ancillary activities as soon as practicable and to the satisfaction of the Commission.
4. The permit holder will notify the Saulneau First Nation Land Use Office two (2) working days prior to project commencement.
5. The permit holder will notify the Mcleod Lake Indian Band First Nation Land Use Office two (2) working days prior to project commencement.
6. The permit holder will notify the Halfway River First Nation Land Office two (2) working days prior to project commencement.
7. The permit holder will notify the West Moberly First Nations Lands Use Department two (2) working days prior to project commencement.
8. Prior to the expiry of this permit, the permit holder must re-vegetate, using seed or vegetative propagules of an ecologically suitable species or implement other measures, to the satisfaction of the Commission, that promote the restoration of the wildlife habitat that existed on the area before the activity was begun.
9. The permit holder must undertake dust control measures to ensure that dust resulting from permitted activities does not affect safe travel on a road or significantly impair the use and enjoyment of lawfully occupied permanent dwellings, significant public use areas, areas known to be traditionally used by First Nations, or other similar areas.

ADVISORY GUIDANCE

1. In accordance with section 32(1&2) of the *Oil and Gas Activities Act* and subject to section 8 of the General Regulation, this Road Permit expires two years from the date of issuance if the Road Permit holder has not begun the construction of the road as permitted. Subject to section 32(2) of OGAA the Permit holder may apply for an extension of the prescribed period.
2. As required under section 4 of the Oil and Gas Road Regulation the Permit holder must notify the Commission, affected landowners and affected rights holders of the construction of an oil and gas road not more than 30 days and not less than 72 hours before beginning construction or as soon as practicable if construction must be carried out as expeditiously to address an environmental or operational emergency. The notice requirements are described in section 4(2) of the OGRR.
3. As required under section 11 of the OGRR, within 60 days of completion of the construction this oil and gas road, the Road Permit holder must submit to the Commission a report in the form and manner specified by the Commission, describing the location of the constructed road.
4. In accordance with section 16 of the OGRR, a Road Permit holder may not (a) close the oil and gas road, or (b) restrict the use of the road by the Permit holder or other person, except as provided under section 20 Oil and Gas Road Regulation or to the extent necessary to carry out maintenance on the road as required under this legislation.
5. In accordance with section 23 of the OGRR, a Road Permit holder who intends to deactivate an oil and gas road must provide written notice of the intention to users of the road known to the Road Permit holder, any applicable landowner and the Commission. Notice requirements and timelines are described in section 23(2&3).
6. The Environmental Protection and Management Regulation (EPMR) has been amended to incorporate oil and gas roads and defining operating areas and thus the Permit holder must ensure that all activities associated with the construction, maintenance and deactivation of an oil and gas road must abide by the pertinent requirements as prescribed in the EPMR.
7. Upon the expiration of the "permitted road", if the permit holder has not begun the permitted activity within the permit expiration period all related authorizations will also be deemed to have expired.

RELATED AUTHORIZATIONS ASSOCIATED WITH THE PERMIT

Cutting Permit under Master Licence to Cut under section 47.4 of the Forest Act

1. The Commission hereby issues the Permit holder Cutting Permit No. 15 under Master Licence to Cut number M02370, subject to the following conditions:
 - a. This Cutting Permit is subject to the terms and conditions in the Master Licence to Cut.
 - b. This Cutting Permit applies to only the Crown land portion shown on survey plan associated with this Permit (survey plan number: WSP File: 130402SK17R4, revision 4, dated May 29, 2015).
 - c. All harvested Crown timber must be marked with Timber Mark Number MTB 393.
 - d. This Cutting Permit is deemed spent upon the submission of the "Post-Construction Plan" or upon either the cancellation or the expiry of the "permitted oil and gas activity".
 - e. This Cutting Permit does not grant the Permit Holder the exclusive right to harvest timber from the License area and the Commission reserves the right to grant rights to other persons to harvest timber from the License area.
 - f. The felling, bucking and utilization specifications as described in Appendix A of your Master License to Cut applies to this Cutting Permit.
 - g. Stumpage for this Cutting Permit will be calculated as per Table 6.6 in the Interior Appraisal Manual.
 - i. Stumpage billing will be calculated on the gross project area. The amount billed will be determined upon submission of the final Post-Construction Plan to the Commission
 - h. Timber that is stored in decks or piles must be marked with the correct timber mark before transportation, or at the end of every shift. The marking must be applied to one end of at least 10% of the timber pieces in each deck or pile using a hammer indentation or paint. Marking must be kept concurrent with decking.
 - i. Where the Permit Holder is aware of overlapping forest tenure rights that have been granted to other persons, the Permit Holder is obligated to communicate to these persons the timing and extent of their harvest operations at least two weeks prior to commencement of harvest and take all reasonable steps to coordinate their activities with these persons.
 - j. In accordance with the Master Licence to Cut referenced above, "Within 60 days of completing operations on a Cutting Permit, the Licensee shall submit to the Commission a map showing all disturbances that have occurred pursuant to that Cutting Permit, at a scale of 1:20,000 or 1:50,000".

Changes in and about a Stream Authorization under section 9 of the *Water Act*

The Oil and Gas Commission hereby authorizes the holder under section 9 of the *Water Act* to make changes in and about streams, as shown on survey plan number: WSP File: 130402SK17R4, revision 4, dated May 29, 2015, subject to the following conditions

1. Any substance, sediment, debris or material that could adversely impact the stream must not be allowed or permitted to enter or leach or seep into the stream from an activity, construction, worksite, machinery or from components used in the construction of any works, or must not be placed, used or stored within the stream channel.
2. Temporary material, fill, bridge, culvert, pump, pipe, conduit, ditch or other structure used in the construction of any works must be constructed and maintained only during the period of construction, and must be removed upon completion of the works.
3. Activities associated with the stream crossing are carried out in accordance with the regional and/or species-specific timing windows or the period(s) of time in the year when the change can proceed without causing serious harm to fish, wildlife or habitat;
4. The stream crossing is constructed and maintained at times and in a manner that will not cause serious harm to fish that are parts of a commercial, recreational or Aboriginal (CRA) fishery, as defined under Section 35 of the *Fisheries Act*.
5. This Section 9 authorization for changes in and about a stream extends to include any necessary ongoing road maintenance activities for streams classified as S6 (less than 3 meters wide containing no fish) and non-classified drainages, and is subject to the following conditions:
 - a. Any substance, sediment, debris or material that could adversely impact the stream must not be allowed or permitted to enter or leach or seep into the stream from an activity, construction, worksite, machinery or from components used in the construction of any works, or must not be placed, used or stored within the stream channel.

- b. Temporary material, fill, bridge, culvert, pump, pipe, conduit, ditch or other structure used in the construction of any works must be constructed and maintained only during the period of construction, and must be removed upon completion of the works.
- c. All other streams will require a separate Section 9 authorization for any maintenance activities requiring in-stream work.

AGRICULTURAL LAND COMMISSION EXEMPTIONS

- 1. The Permit hold must in relation to any oil and gas activities and related activities that are authorized herein and are located within the Agricultural Land Reserve:
 - a. Implement any recommendations for soil handling and management of surface water contained in the Schedule A Report dated January 22, 2015; and
 - b. conduct reclamation of any area of land disturbed by non-farm use in accordance with any recommendations contained in the Schedule A Report and the requirements set out in Schedule B of the Agreement between the Provincial Agricultural Land Commission and the Oil and Gas Commission dated June 13, 2013, or in accordance with such alternate requirements identified by a Qualified Specialist and agreed to by the Commission,
 - i. within 24 months of the date that the use of the area of land disturbed by the non-farm use is no longer required for the oil and gas activity or ancillary activity; and
 - ii. immediately following completion of (a), above, submit a Schedule B Report to the Commission and to the landowner.

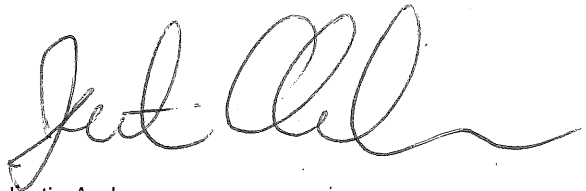

Justin Anderson
Authorized Signatory
Commission Delegated Decision Maker

- pc. Roy Northern Land Service Ltd.
OGC File: 9641911
OGC First Nations (Halfway River First Nation, Mcleod Lake Indian Band, Saulteau First Nation, West Moberly First Nations, Blueberry River First Nation, Kelly Lake Cree Nation, Kelly Lake First Nation, Kelly Lake Metis Society)
MoFLNRO, Peace

NOTES:
 Distances shown are in meters and decimals thereof.
 Contours on plan are generated from lidar data and they are shown at 20m intervals.
 Project to be flagged at time of construction.
 Proposed access approached have not been swept for buried facilities.
 Proposed site within Hudson's Hope District Municipality
 The nearest occupied dwelling is located 2.77km East of proposed Compressor location.
 The nearest urban centre is Hudson's Hope located 9.9km North of proposed Compressor location.
 This project is partially within the Agricultural Land Reserve

Cutblock data is confirmed using information from the Government of BC websites for Forest MapView and iMapBC. Information from these sources can be subject to change without notice. WSP Surveys (BC) and its employees take no responsibility for accuracy or completeness of this information.

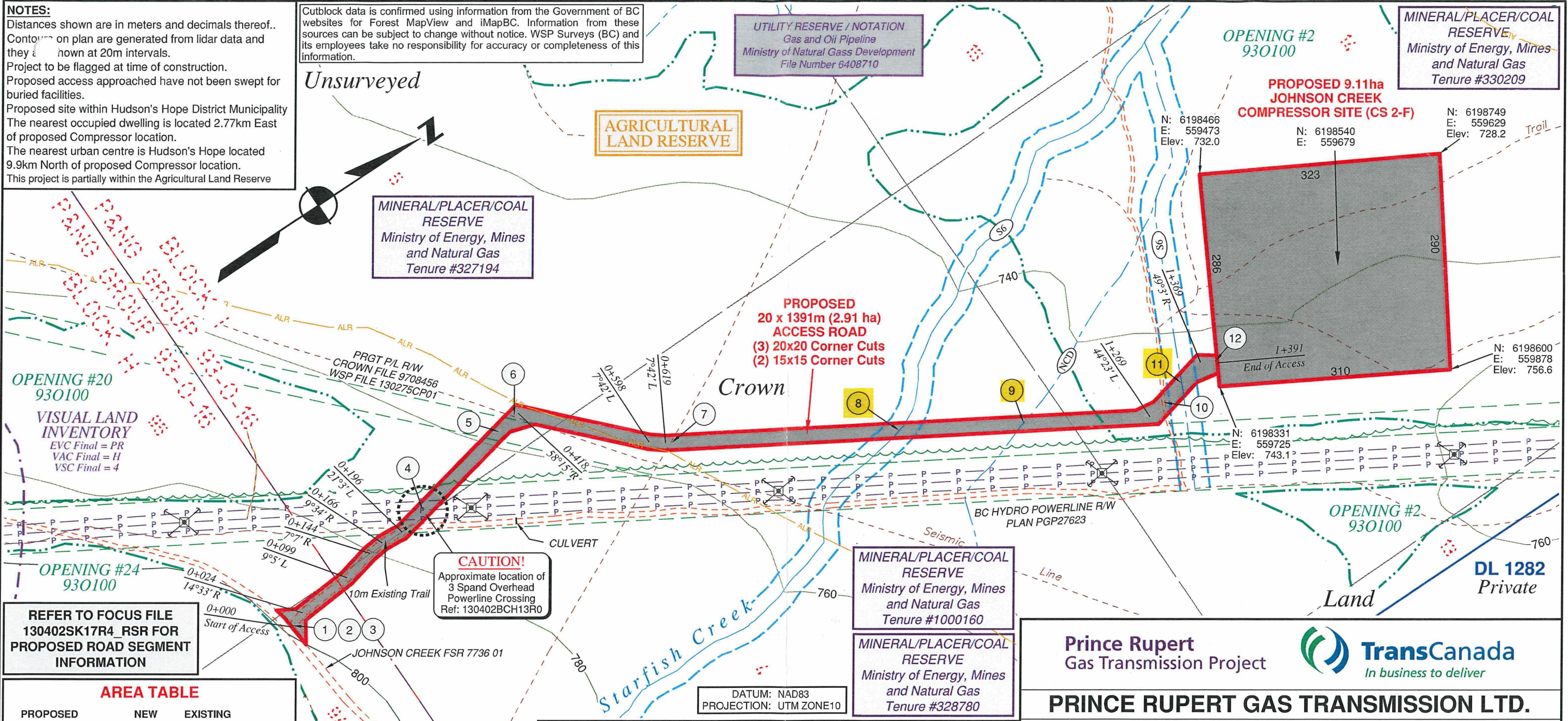

REFER TO FOCUS FILE 130402SK17R4_RSR FOR PROPOSED ROAD SEGMENT INFORMATION

AREA TABLE

PROPOSED FEATURE	NEW CUT	EXISTING CLEARING	TOTAL
Within Crown Land			
Access Road	2.54 ha	0.37 ha	2.91 ha
TOTAL AREAS	2.54 ha	0.37 ha	2.91 ha

AREA TABLE

PROPOSED FEATURE	NEW CUT	EXISTING CLEARING	TOTAL
Within Crown Land			
Compressor Site	9.11 ha	0.00 ha	9.11 ha
TOTAL AREAS	9.11 ha	0.00 ha	9.11 ha

COMPRESSOR SITE LOCATION

NAD 83 UTM Coordinates	NAD 83 Geodetic Coordinates
N 6198540.051 E 559679.196	55° 55' 42.7976" N 122° 02' 41.4740" W

LEGEND:

- Proposed Area
- Agricultural Land Reserve
- Drainage
- Road
- Visual Land Inventory (VLI)
- Cutblock
- Right of Way
- Powerline
- Seismic line/trail
- Riparian Reserve Zone
- Riparian Management Zone
- Bushline
- Stantec classified S6 Riparian Class
- Non Classified Drainage
- Transmission Tower
- Anchor

TABLE OF CROSSINGS

No.	STATION	DESCRIPTION	NAD 83 UTM ZONE 10	OWNER
1	0+000	Start of Proposed Access Road	N: 6197122 E: 559303	PRGT
2	0+000	Johnson Creek FSR 7736 01	N: 6197122 E: 559303	CROWN
3	0+000	Existing Trail	N: 6197122 E: 559303	CROWN
4	0+235	Powerline R/W PGP 27623	N: 6197353 E: 559271	BC HYDRO
5	0+382	Pipeline R/W Crown File 9708456	N: 6197497 E: 559240	PRGT
6	0+411	Trim Trail	N: 6197524 E: 559234	CROWN
7	0+627	Trim Trail	N: 6197679 E: 559380	CROWN
8	0+935	Starfish Creek/ S6/ RRZ= 0 RMA= 20	N: 6197944 E: 559537	CROWN
9	1+099	Tributary to Starfish Creek/ NCD / RRZ= 0 RMZ= 0	N: 6198085 E: 559621	CROWN
10	1+296	Existing Trail	N: 6198257 E: 559702	CROWN
11	1+331	Tributary to Starfish Creek/ S6/ RRZ= 0 RMA= 20	N: 6198292 E: 559693	CROWN
12	1+391	End of Proposed Access Road	N: 6198346 E: 559697	PRGT

NOTE: This plan represents the best information available at the time of survey. WSP Surveys and its employees take no responsibility for the location of any underground conduits, pipes, or other facilities whether shown on or omitted from this plan. All underground installations should be located by the respective authorities prior to construction.

Prince Rupert Gas Transmission Project **TransCanada**
 In business to deliver

PRINCE RUPERT GAS TRANSMISSION LTD.

SKETCH PLAN SHOWING PROPOSED 9.11 ha JOHNSON CREEK COMPRESSOR SITE (CS 2-F) AND ACCESS ROAD FROM c-94-H, 93-O-16 TO a-14-I, 93-O-16, ALL WITHIN UNITS 4, 5 AND 14, BLOCK I AND UNITS 94 AND 95, BLOCK H, 93-O-16
 Unsurveyed Crown Land, Peace River District

100 0 100 200 300 400

The intended plot size of this plan is 432mm in width by 280mm in height when plotted at a scale of 1: 5000 (use B size sheet)

BCGS: 93O.100

Rev	Revision Description	Date(Y/M/D)	By
0	Original Plan Prepared	2014/06/03	TR
4	Updated Stantec watercourse crossings	2015/05/29	TW

WSP Surveys (BC) Limited Partnership
 Fort St John BC (250) 787-0300

WSP FILE: 130402SK17R4
 Compressor Site ePASS: 10048830
 Access Road ePASS: 10048849
 Sheet: 1 of 1

REV. 4

9641911