

NOTES:
 Distances shown are in meters and decimals thereof.
 Contours on plan are generated from lidar data and they are shown at 20m intervals.
 Project to be flagged at time of construction.
 Proposed access approached have not been swept for buried facilities.
 Proposed site within Hudson's Hope District Municipality
 The nearest occupied dwelling is located 2.77km East of proposed Compressor location.
 The nearest urban centre is Hudson's Hope located 9.9km North of proposed Compressor location.
 This project is partially within the Agricultural Land Reserve

Cutblock data is confirmed using information from the Government of BC websites for Forest MapView and iMapBC. Information from these sources can be subject to change without notice. Focus Surveys (BC) and its employees take no responsibility for accuracy or completeness of this information.

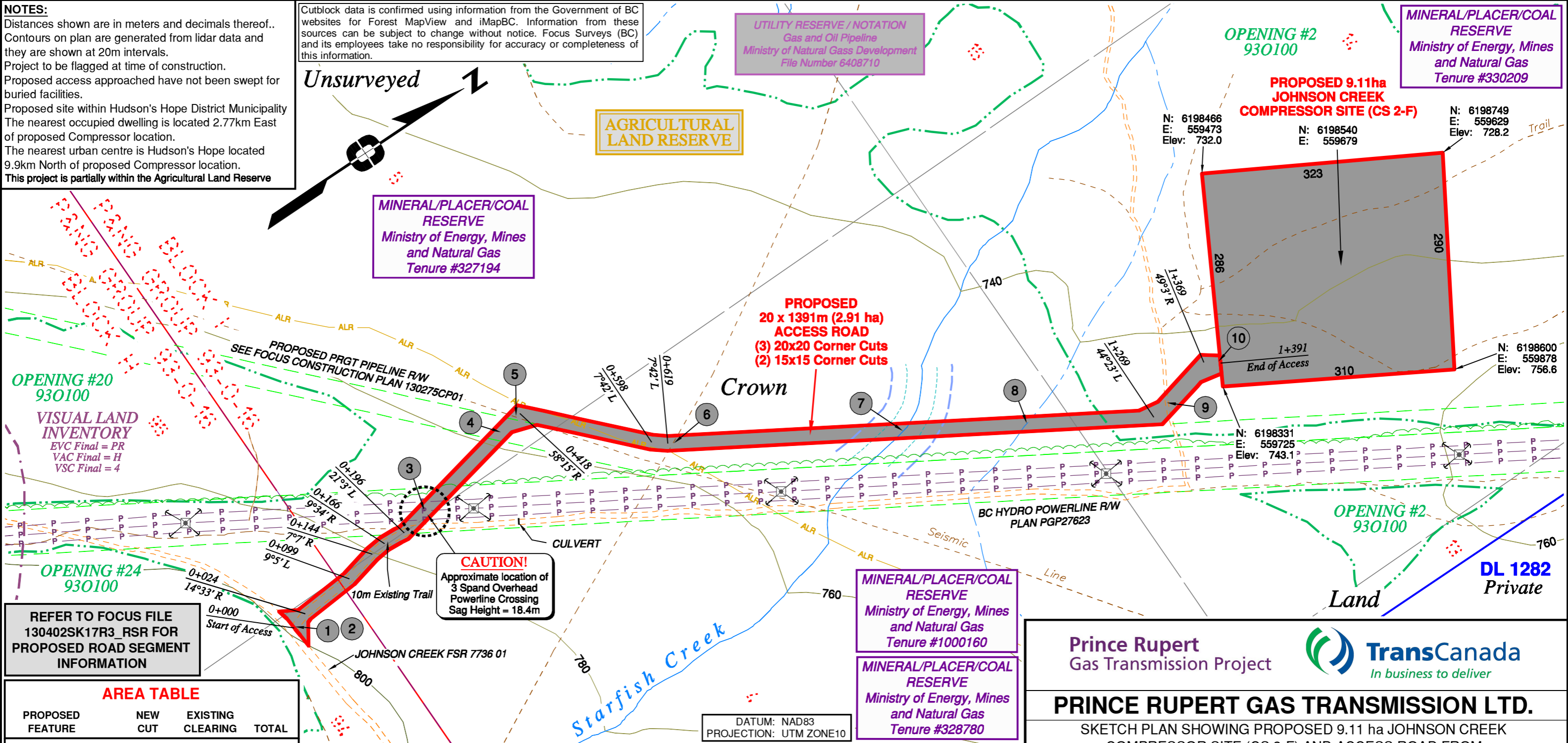

OPENING #20
 930100
VISUAL LAND INVENTORY
 EVC Final = PR
 VAC Final = H
 VSC Final = 4

REFER TO FOCUS FILE
 130402SK17R3_RSR FOR
 PROPOSED ROAD SEGMENT
 INFORMATION

AREA TABLE

PROPOSED FEATURE	NEW CUT	EXISTING CLEARING	TOTAL
Within Crown Land			
Access Road	2.54 ha	0.37 ha	2.91 ha
TOTAL AREAS	2.54 ha	0.37 ha	2.91 ha

AREA TABLE

PROPOSED FEATURE	NEW CUT	EXISTING CLEARING	TOTAL
Within Crown Land			
Compressor Site	9.11 ha	0.00 ha	9.11 ha
TOTAL AREAS	9.11 ha	0.00 ha	9.11 ha

COMPRESSOR SITE LOCATION

NAD 83 UTM Coordinates	NAD 83 Geodetic Coordinates
N 6198540.051 E 559679.196	55° 55' 42.7976" N 122° 02' 41.4740" W

LEGEND:

- Proposed Area
- Agricultural Land Reserve ALR
- Drainage
- Road
- Visual Land Inventory (VLI)
- Cutblock
- Right of Way
- Powerline
- Seismic line/trail:
- Riparian Reserve Zone:
- Riparian Management Zone:
- Bushline:
- Transmission Tower:
- Anchor:

TABLE OF CROSSINGS

No.	STATION	DESCRIPTION	NAD 83 UTM ZONE10	OWNER
10	1+391	End of Proposed Access Road	N: 6198346 E: 559697	PRGT
9	1+296	Existing Trail	N: 6198257 E: 559702	CROWN
8	1+099	Non-Classified Drainage/ RRZ= 0 RMZ= 0	N: 6198085 E: 559621	ILMB
7	0+935	Starfish Creek/ S3/ RRZ= 20 RMA= 20	N: 6197944 E: 559537	ILMB
6	0+627	Trim Trail	N: 6197679 E: 559380	CROWN
5	0+411	Trim Trail	N: 6197524 E: 559234	CROWN
4	0+382	Proposed Pipeline	N: 6197497 E: 559240	PRGT
3	0+235	Powerline R/W PGP 27623	N: 6197353 E: 559271	BC HYDRO
2	0+000	Existing Trail	N: 6197122 E: 559303	CROWN
1	0+000	Start of Proposed Access Road	N: 6197122 E: 559303	PRGT

NOTE: This plan represents the best information available at the time of survey. Focus Surveys and its employees take no responsibility for the location of any underground conduits, pipes, or other facilities whether shown on or omitted from this plan. All underground installations should be located by the respective authorities prior to construction.

Prince Rupert Gas Transmission Project **TransCanada**
In business to deliver

PRINCE RUPERT GAS TRANSMISSION LTD.

SKETCH PLAN SHOWING PROPOSED 9.11 ha JOHNSON CREEK COMPRESSOR SITE (CS 2-F) AND ACCESS ROAD FROM c-94-H, 93-O-16 TO a-14-I, 93-O-16, ALL WITHIN UNITS 4, 5 AND 14, BLOCK I AND UNITS 94 AND 95, BLOCK H, 93-O-16
 Unserved Crown Land, Peace River District

BCGS: 930.100

The intended plot size of this plan is 432mm in width by 280mm in height when plotted at a scale of 1: 5000 (use B size sheet)

Rev	Revision Description	Date(Y/M/D)	By
0	Original Plan Prepared	2014/06/03	TR
3	Updated Compressor Site Location and Access Road	2014/09/18	TW/RD

FOCUS
 Focus Surveys (BC) Limited Partnership
 10716 - 100th Avenue Fort St John BC
 V1J 1Z3 250.787.0300 www.focus.ca

FOCUS: 130402SK17R3
 Compressor Site ePASS: 10048830
 Access Road ePASS: 10048849
 Sheet: 1 of 1

REV. 3