

Rev	Revision Description	Date(Y/M/D)	By
0	Original Plan Prepared	2014/09/19	DC
1	Construction Plan Based on Rev.0 (2014/09/12) Except for New Construction Corridor: Shape, Label, Area Table & ePass Corrected Area on (S1)	2014/12/31	DC

NOTES:

- Co-ordinates are NAD 83 Grid, UTM Zone 9 and Zone 10. Distances shown are in metres and decimals thereof. Chainages are two-dimensional and are on pipeline ditchline. Pipeline segment length derived from ditchline chainages.
- Fault Lines data has been provided from BGC Engineering Inc. Desktop Study dated December 20, 2013.
- Water crossing information has been provided by Stantec. Wetlands data has been provided by Stantec dated August 29, 2014. Freshwater Atlas wetlands outside of construction corridor have been removed from scenery.
- Cutblock data is confirmed using information from the Government of BC websites for Forest MapView and MapBC.
- This pipeline section is partially within the Agricultural Land Reserve.
- Field Survey Completed July 15, 2014
- This plan represents the best information available at the time of survey. Focus Surveys and its employees take no responsibility for the location of any underground conduits, pipes, or other facilities whether shown on or omitted from this plan. All underground installations should be located by the respective authorities prior to construction.

LEGEND
Proposed Pipeline R/W shown thus:
Proposed Temp. Workspaces shown thus:
Proposed Log Decks & Storage Sites shown thus:
Right of Way shown thus:
Roads shown thus:
Highway shown thus:
Railway line shown thus:
Seismic line/trail shown thus:
Recreation Tenure shown thus:
Drainages shown thus:
Buried cable shown thus:
Buried pipe shown thus:
Overhead powerline shown thus:
Riparian Reserve Zone shown thus:
Riparian Management Zone shown thus:
Forest Cover Reserve shown thus:
Archaeological site shown thus:
Agricultural Land Reserve shown thus:
Coal Tenure bdy shown thus:
Fence bdy shown thus:
Fish/Wildlife Reserve bdy shown thus:
Grazing Tenure bdy shown thus:
Mineral Claim bdy shown thus:
Tree Farm Licence shown thus:
Quarry Reserve bdy shown thus:
Ungulate Winter Range bdy shown thus:
Visual Land Inventory shown thus:
Watershed Reserve bdy shown thus:
Wind Tenure bdy shown thus:
Woodlot bdy shown thus:
Fault Line shown thus:
Misc. Reserve/Notation bdy shown thus:
Misc. Licence/Permit bdy shown thus:
Nisga'a Lands shown thus:
Nisga'a Village Lands shown thus:
Lava Bed Park shown thus:

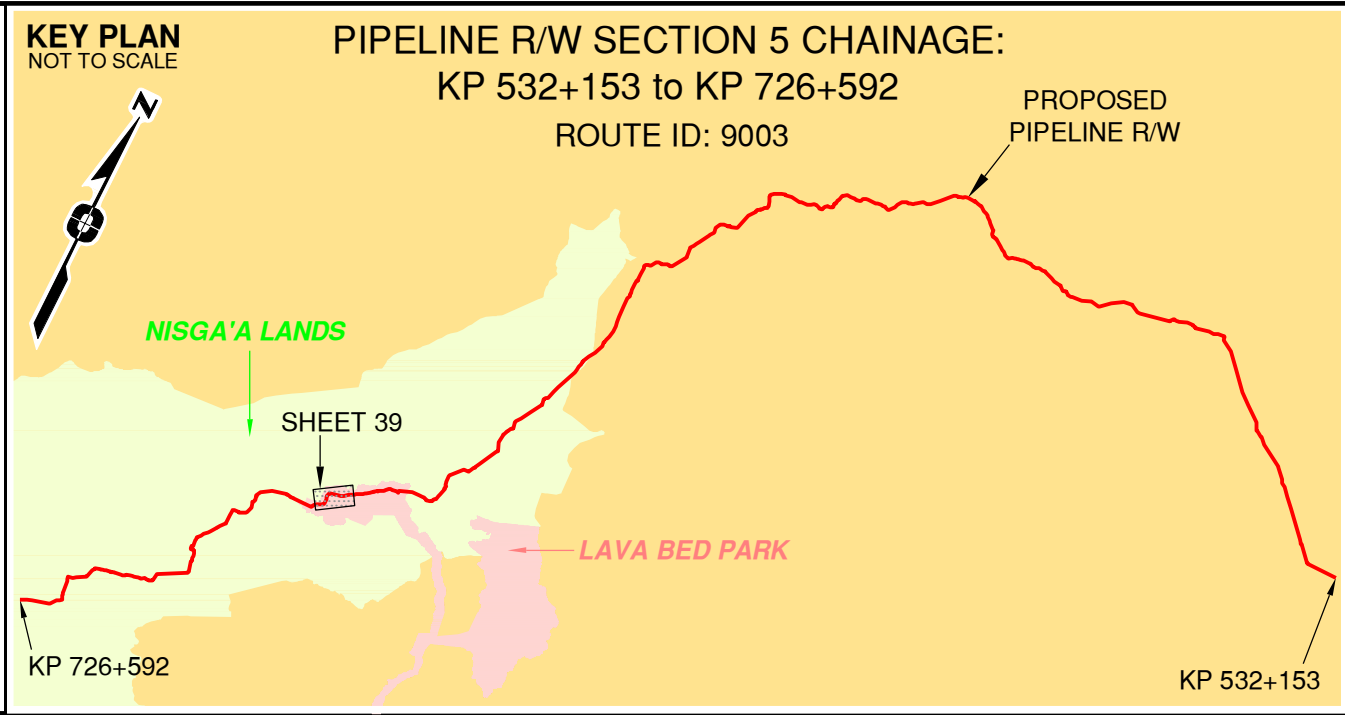

APPROVED BY
PROJECT ENGINEER

No.	STATION	DESCRIPTION	NAD 83 UTM ZONE 9	ILMB	OWNER
W02009	(S1) 681+810	Trib to the Nass River / Non-classified drainage / RRZ=0 RMZ=0	N 6115736 E 487605	ILMB	

TABLE OF CROSSINGS

Prince Rupert Gas Transmission Project

TransCanada  
In business to deliver

**PRINCE RUPERT GAS TRANSMISSION LTD.**

PROPOSED VARIABLE WIDTH (32 to 90m) PIPELINE R/W FROM d-59-I, 93-M-5 TO c-71-D, 103-P-3 (S1), c-71-D TO d-63-D, 103-P-3 (S2 & S3) & FROM d-63-D, 103-P-3 TO a-71-J, 103-I-13 (S4) (SHEET CHAINAGE: 681+153 TO 685+539)

Unsurveyed Crown Land/Crown Land/Private Land/Nisga'a Lands & Village Lands/Lava Bed Park/Cassiar District & Range 5 Coast District

BCGS: 1031.092/93.93M.042/51/52/61, 103P.003/04/14/15/25/26/36/46/56/57/67/68/69/70

The intended plot size of this plan is 864mm in width by 560mm in height when plotted at a scale of 1: 5000 (use D size sheet)

Sheet 39 of 49

**FOCUS**  
Focus Surveys (BC) Limited Partnership  
10716 - 100th Avenue Fort St. John BC  
V1J 1Z3 250.757.0300 www.focus.ca

**FOCUS:**  
AFPE: 130275CP05R1  
TCPL: 5005948  
ePASS: 004776-09-ML-03-175  
10048852

REV. 1



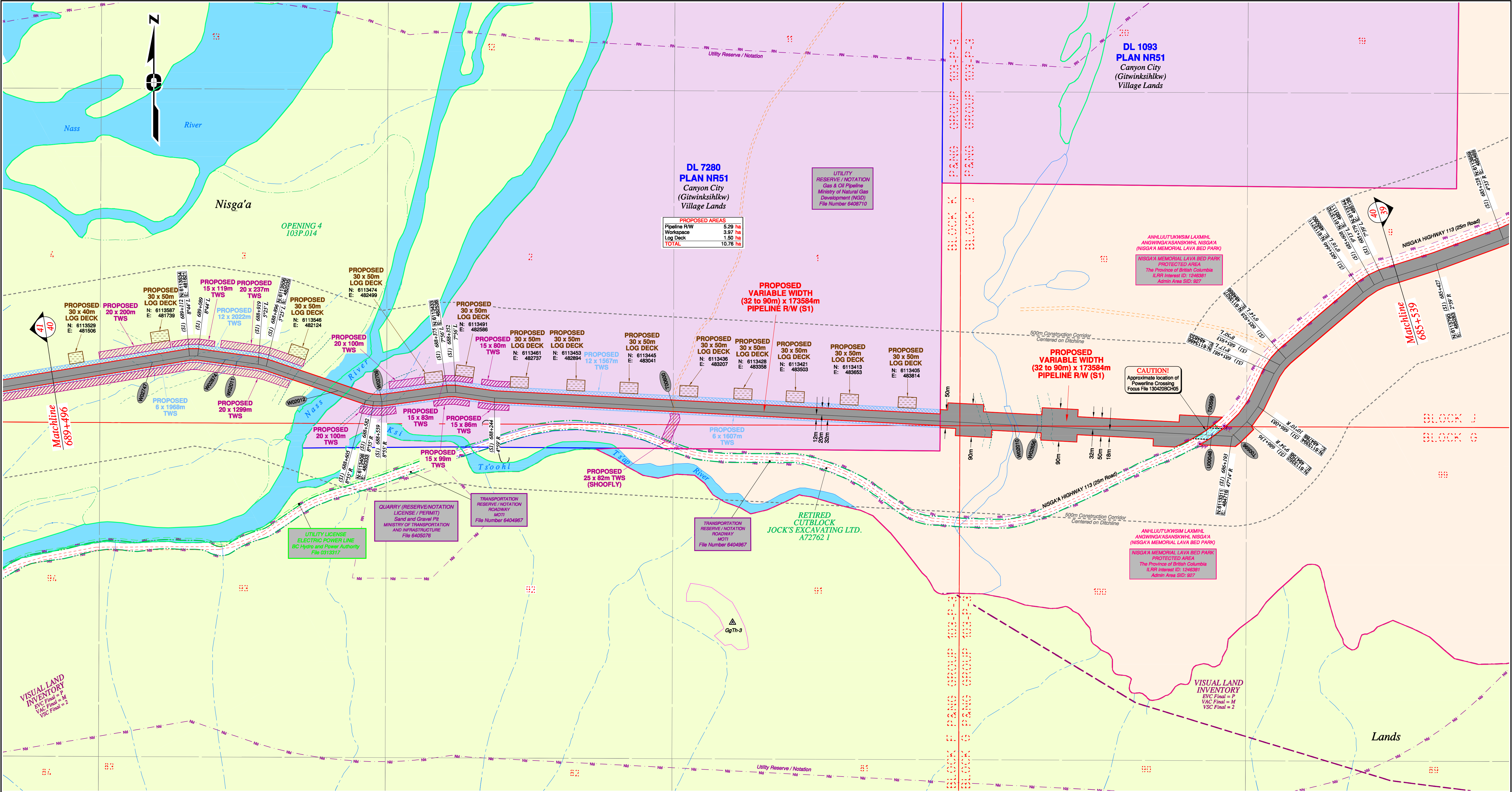

Rev	Revision Description	Date(Y/M/D)	By
0	Original Plan Prepared	2014/09/19	DC
1	Construction Plan Based on Rev.0 (2014/09/12) Except for New Construction Corridor: Shape, Label, Area Table & ePass Corrected Area on (S1)	2014/12/31	DC

NOTES:

- Co-ordinates are NAD 83 Grid, UTM Zone 9 and Zone 10. Distances shown are in metres and decimals thereof. Chainages are two-dimensional and are on pipeline ditchline. Pipeline segment length derived from ditchline chainages.
- Fault Lines data has been provided from BGC Engineering Inc. Desktop Study dated December 20, 2013.
- Water crossing information has been provided by Stantec. Wetlands data has been provided by Stantec dated August 29, 2014. Freshwater Atlas wetlands outside of construction corridor have been removed from scenery.
- Cutblock data is confirmed using information from the Government of BC websites for Forest Map View and MapBC.
- This pipeline section is partially within the Agricultural Land Reserve.
- Field Survey Completed July 15, 2014.
- This plan represents the best information available at the time of survey. Focus Surveys and its employees take no responsibility for the location of any underground conduits, pipes, or other facilities whether shown on or omitted from this plan. All underground installations should be located by the respective authorities prior to construction.

LEGEND
Proposed Pipeline R/W shown thus:
Proposed Temp. Workspaces shown thus: TWS / TWS
Proposed Log Decks & Storage Sites shown thus:
Right of Way shown thus:
Roads shown thus:
Highway shown thus:
Railway line shown thus:
Seismic line/trail shown thus:
Recreation Tenure shown thus:
Drainages shown thus:
Buried cable shown thus:
Buried pipe shown thus:
Overhead powerline shown thus:
Forest Cover Reserve shown thus:
Riparian Reserve Zone shown thus:
Archaeological site shown thus:
Agricultural Land Reserve shown thus:
Coal Tenure bdy shown thus:
Cutblock bdy shown thus:
Fence bdy shown thus:
Fish/Wildlife Reserve bdy shown thus:
Grazing Tenure bdy shown thus:
Mineral Claim bdy shown thus:
Tree Farm Licence shown thus:
Quarry Reserve bdy shown thus:
Ungulate Winter Range bdy shown thus:
Visual Land Inventory shown thus:
Watershed Reserve bdy shown thus:
Wind Tenure bdy shown thus:
Woodlot bdy shown thus:
Fault Line shown thus:
Misc. Reserve/Notation bdy shown thus:
Misc. Licence/Permit bdy shown thus:
Stantec Wetland / Classification shown thus:
Crossings shown thus:
Old Growth Management Area shown thus:
Residences shown thus:
Nisga'a Lands shown thus:
Nisga'a Village Lands shown thus:
Lava Bed Park shown thus:

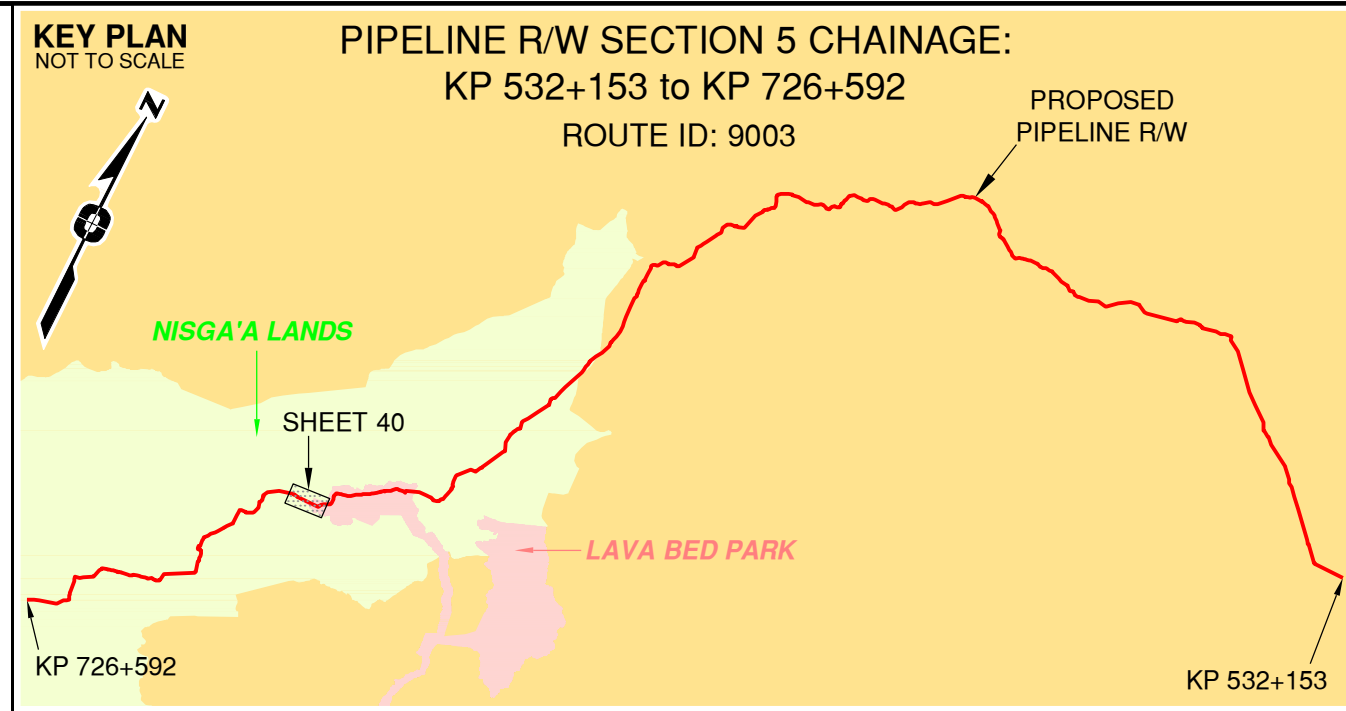

APPROVED BY
PROJECT ENGINEER

No.	STATION	DESCRIPTION	OWNER
W02747	(S1) 689+217	Trib to Nass River / S4 / RRZ-0 RMZ=30	N 6113517 E 481719 ILMB
W02874	(S1) 689+012	Trib to Nass River / S4 / RRZ-0 RMZ=30	N 6113524 E 481923 ILMB
W02011	(S1) 688+979	Trib to Nass River / Non-classified drainage / RRZ-0 RMZ=0	N 6113519 E 481954 ILMB
W02012	(S1) 688+686	Nass River Side Channel / S1 / RRZ-50 RMZ=20	N 6113438 E 482234 ILMB
W02709	(S1) 688+560	Trib to Nass River / S4 / RRZ-0 RMZ=30	N 6113408 E 482356 ILMB
T00600	(S1) 687+747	Road / Condition Unknown	N 6113392 E 483165 Nisga'a Usims Government
W02010	(S1) 686+799	Trib to Ksi Ts'ooih Ts'ap Creek / S1 / RRZ-50 RMZ=20	N 6113343 E 484112 ILMB
W02656	(S1) 686+733	Trib to Ksi Ts'ooih Ts'ap Creek / S4 / RRZ-0 RMZ=30	N 6113339 E 484178 ILMB
W00599	(S1) 686+266	Nisga'a Highway 113 / Paved	N 6113315 E 484655 MOTI
U00048	(S1) 686+251	Overhead Powerline	N 6113314 E 484659 BC Hydro
T00596	(S1) 685+188	Trail / Condition Unknown	N 6113315 E 484720 Nisga'a Usims Government

Prince Rupert Gas Transmission Project

TransCanada  
In business to deliver

**PRINCE RUPERT GAS TRANSMISSION LTD.**

PROPOSED VARIABLE WIDTH (32 to 90m) PIPELINE R/W FROM d-59-I, 93-M-5 TO c-71-D, 103-P-3 (S1), c-71-D TO d-63-D, 103-P-3 (S2 & S3) & FROM d-63-D, 103-P-3 TO a-71-J, 103-I-13 (S4) (SHEET CHAINAGE: 685+539 TO 689+496)

Unsurveyed Crown Land/Crown Land/Private Land/Nisga'a Lands & Village Lands/Lava Bed Park Cassiar District & Range 5 Coast District

The intended plot size of this plan is 864mm in width by 560mm in height when plotted at a scale of 1: 5000 (use D size sheet)

BCGS: 1031.092/93.93M.042/51/52/61, 103P.003/04/14/15/25/26/36/46/56/67/68/69/70

Sheet 40 of 49

**FOCUS**  
Focus Surveys (BC) Limited Partnership  
10716 - 100th Avenue Fort St John BC  
V1J 1Z3 250.787.0300 www.focus.ca

FOCUS: 130275CP05R1  
AFCL: 5005948  
TCPL: 004776-00-ML-03-176  
ePASS: 10048852

REV. 1



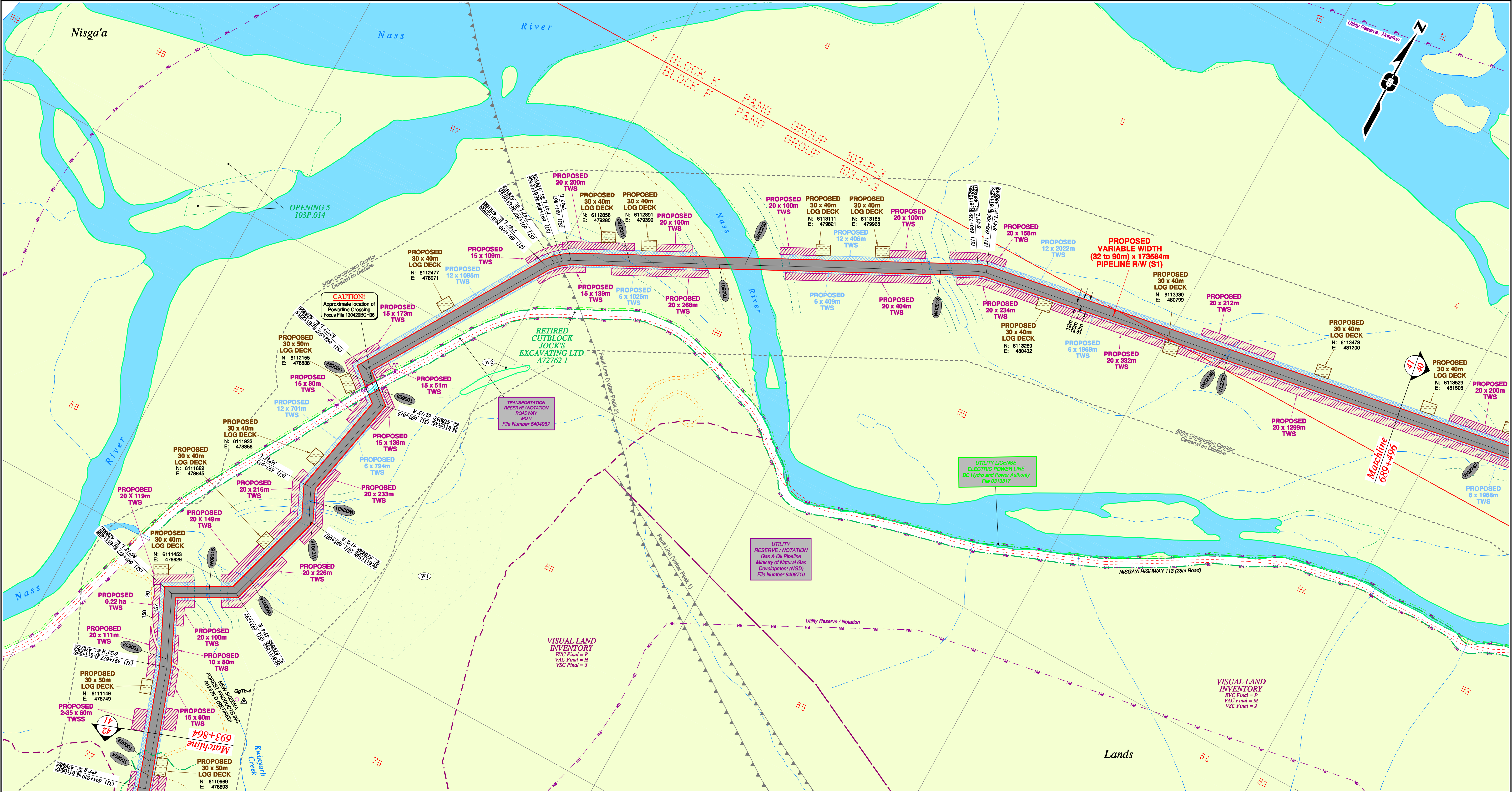

Rev	Revision Description	Date(Y/M/D)	By
0	Original Plan Prepared	2014/09/19	DC
1	Construction Plan Based on Rev.0 (2014/09/12) Except for New Construction Corridor: Shape, Label, Area Table & ePass Corrected Area on (S1)	2014/12/31	DC

NOTES:

- Co-ordinates are NAD 83 Grid, UTM Zone 9 and Zone 10. Distances shown are in metres and decimals thereof. Chainages are two-dimensional and are on pipeline ditchline. Pipeline segment length derived from ditchline chainages.
- Fault Lines data has been provided from BGC Engineering Inc. Desktop Study dated December 20, 2013.
- Water crossing information has been provided by Stantec. Wetlands data has been provided by Stantec dated August 29, 2014. Freshwater Atlas wetlands outside of construction corridor have been removed from scenery.
- Cutblock data is confirmed using information from the Government of BC websites for Forest MapView and MapBC.
- This pipeline section is partially within the Agricultural Land Reserve.
- Field Survey Completed July 15, 2014
- This plan represents the best information available at the time of survey. Focus Surveys and its employees take no responsibility for the location of any underground conduits, pipes, or other facilities whether shown on or omitted from this plan. All underground installations should be located by the respective authorities prior to construction.

LEGEND
Proposed Pipeline R/W shown thus:
Proposed Temp. Workspaces shown thus: TWS / TWS
Proposed Log Decks & Storage Sites shown thus:
Right of Way shown thus:
Roads shown thus:
Highway shown thus:
Railway line shown thus:
Seismic line/trail shown thus:
Recreation Tenure shown thus:
Drainages shown thus:
Buried cable shown thus:
Buried pipe shown thus:
Overhead powerline shown thus:
Riparian Reserve Zone shown thus:
Riparian Management Zone shown thus:
Forest Cover Reserve shown thus:
Archaeological site shown thus:
Agricultural Land Reserve shown thus:
Coal Tenure bdy shown thus:
Cutblock bdy shown thus:
Fence bdy shown thus:
Fish/Wildlife Reserve bdy shown thus:
Grazing Tenure bdy shown thus:
Mineral Claim bdy shown thus:
Tree Farm Licence shown thus:
Quarry Reserve bdy shown thus:
Ungulate Winter Range bdy shown thus: UWR
Visual Land Inventory shown thus:
Watershed Reserve bdy shown thus:
Wind Tenure bdy shown thus:
Woodlot bdy shown thus:
Fault Line shown thus:
Misc. Reserve/Notation bdy shown thus:
Misc. Licence/Permit bdy shown thus:
Crossings shown thus:
Old Growth Management Area shown thus:
Residences shown thus:
Nisga'a Lands shown thus:
Nisga'a Village Lands shown thus:
Lava Bed Park shown thus:

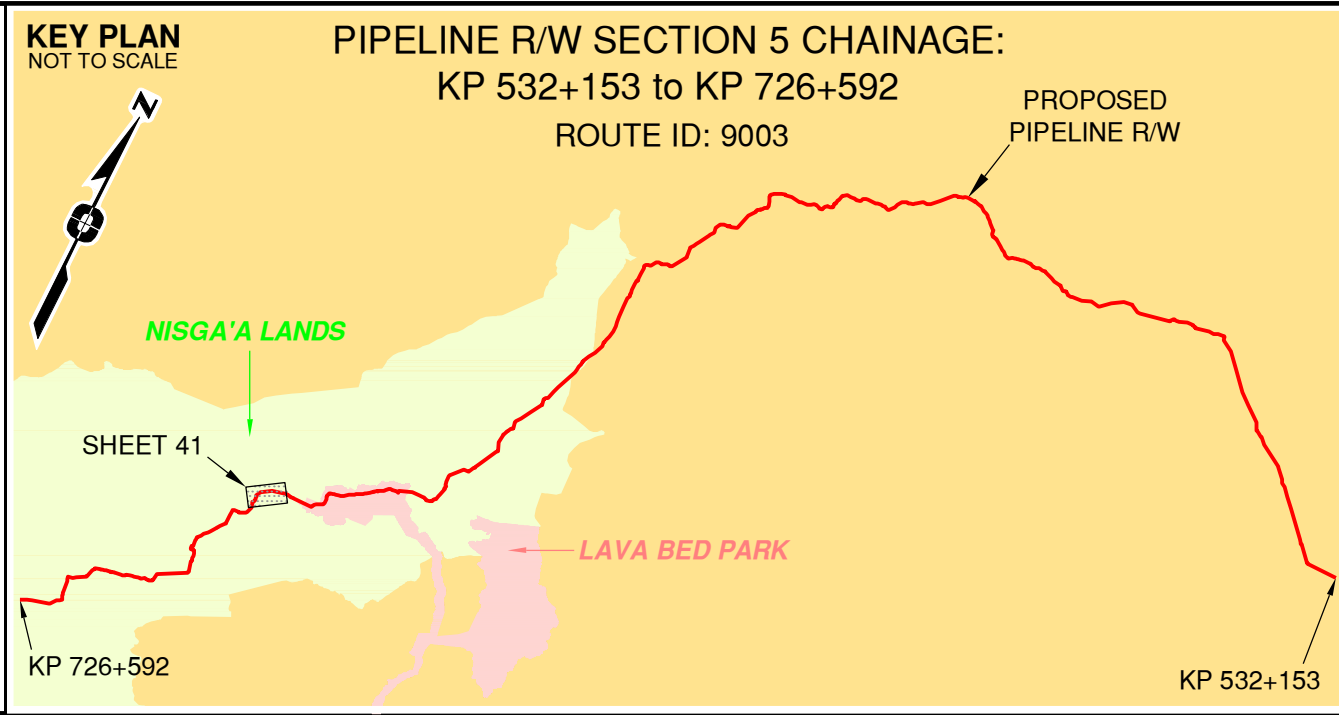

APPROVED BY
PROJECT ENGINEER

No.	STATION	DESCRIPTION	NAD 83 UTM ZONE 9	OWNER
T00602	(S1) 693+655	Forestry Road / Condition Unknown / R12576 D (Retired)	N 611243 E 478764	Nisga'a Lisims Government
W02015	(S1) 693+369	Kwinyarth Creek / S2 / RR2-30 RMZ=20	N 6111458 E 478778	ILMB
W02014	(S1) 693+239	Trib to Kwinyarth Crk / Non-classified drainage / RR2-0 RMZ=0	N 6111547 E 478860	ILMB
W02018	(S1) 692+985	Trib to Kwinyarth Crk / Beaver Dam Complex / RR2-0 RMZ=30	N 6111789 E 478916	ILMB
W02631	(S1) 692+954	Trib to Nass River / RR2-0 RMZ=20	N 6111817 E 478903	ILMB
T00605	(S1) 692+567	Nisga'a Highway 113 / Paved	N 6112177 E 478910	MOTI
U00022	(S1) 692+552	Overhead Powerline	N 6112186 E 478898	BC Hydro
W02760	(S1) 691+698	Trib to Nass River / S4 / RR2-0 RMZ=30	N 6112825 E 479365	ILMB
T00601	(S1) 691+450	Trail / Condition Unknown	N 6112938 E 479585	Nisga'a Lisims Government
W02200	(S1) 691+378	Nass River Side Channel / S1 / RR2-50 RMZ=20	N 6112971 E 479650	ILMB
W02013	(S1) 690+834	Trib to Nass River / RR2-30 RMZ=20	N 6113217 E 480134	ILMB
W02749	(S1) 690+007	Trib to Nass River / S4 / RR2-0 RMZ=30	N 6113387 E 480939	ILMB
W02722	(S1) 689+997	Trib to Nass River / S4 / RR2-0 RMZ=30	N 6113389 E 480949	ILMB

Prince Rupert Gas Transmission Project

TransCanada  
In business to deliver

**PRINCE RUPERT GAS TRANSMISSION LTD.**

PROPOSED VARIABLE WIDTH (32 to 90m) PIPELINE R/W FROM d-59-I, 93-M-5 TO c-71-D, 103-P-3 (S1), c-71-D TO d-63-D, 103-P-3 (S2 & S3) & FROM d-63-D, 103-P-3 TO a-71-J, 103-I-13 (S4) (SHEET CHAINAGE: 689+496 TO 693+864)

Unsurveyed Crown Land/Crown Land/Private Land/Nisga'a Lands & Village Lands/Lava Bed Park Cassiar District & Range 5 Coast District

100 200 300 400

The intended plot size of this plan is 864mm in width by 560mm in height when plotted at a scale of 1: 5000 (use D size sheet)

BCGS: 1031.092/93.93M.042/51/52/61, 103P.003/04/14/15/25/26/36/46/56/57/67/68/69/70

Sheet 41 of 49

**FOCUS**  
Focus Surveys (BC) Limited Partnership  
10716 - 100th Avenue Fort St. John BC  
V1J 1Z3 250.757.0300 www.focus.ca

FOCUS: 130275CP05R1  
AFE: 5005948  
TCPL: 004776-09-ML-03-177  
ePASS: 10048852

REV. 1



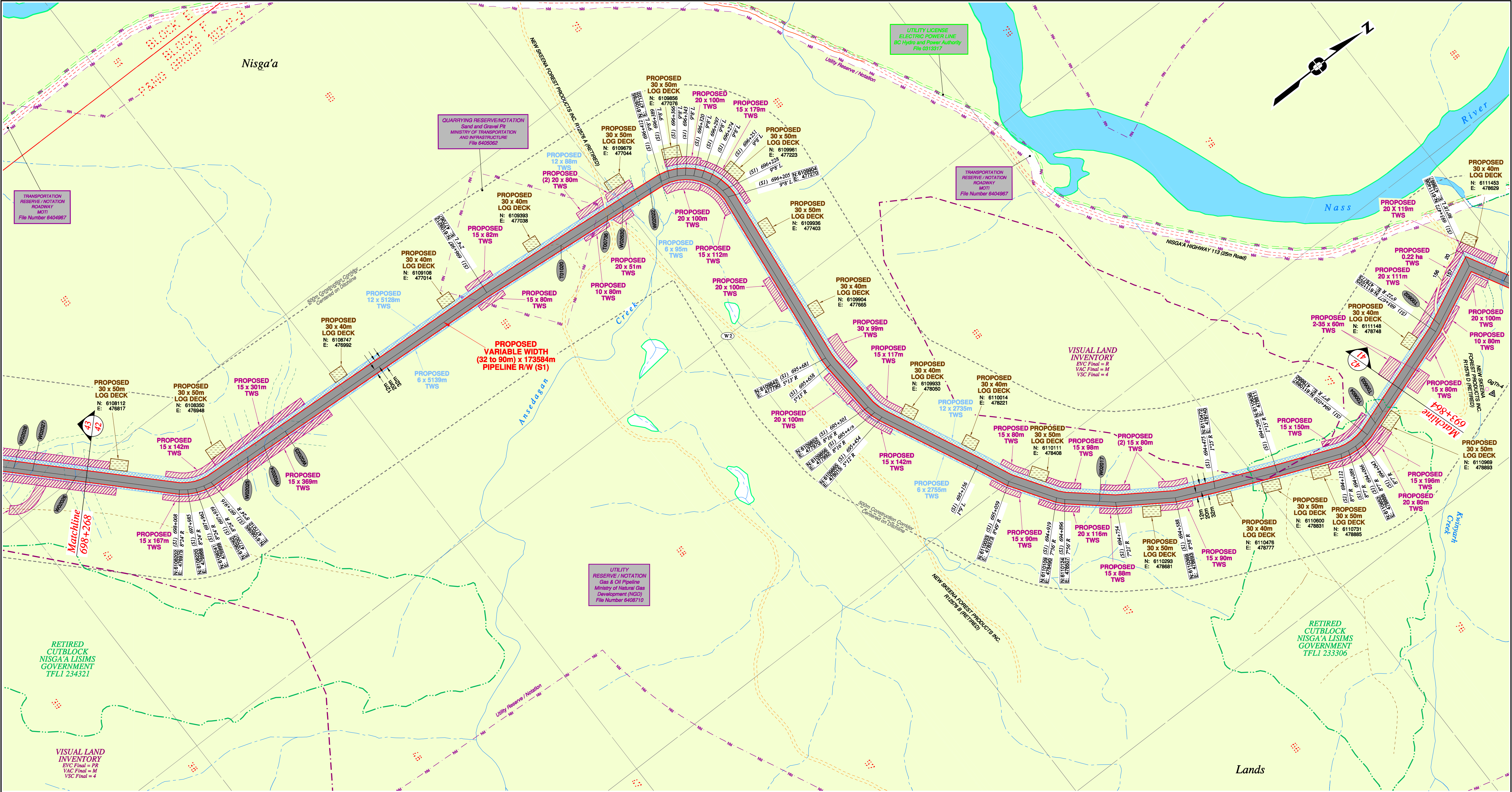

Rev	Revision Description	Date(Y/M/D)	By
0	Original Plan Prepared	2014/09/19	DC
1	Construction Plan Based on Rev.0 (2014/09/12) Except for New Construction Corridor: Shape, Label, Area Table & ePass Corrected Area on (S1)	2014/12/31	DC

NOTES:

- Co-ordinates are NAD 83 Grid, UTM Zone 9 and Zone 10. Distances shown are in metres and decimals thereof. Chainages are two-dimensional and are on pipeline ditchline. Pipeline segment length derived from ditchline chainages.
- Fault Lines data has been provided from BGC Engineering Inc. Desktop Study dated December 20, 2013.
- Water crossing information has been provided by Stantec. Wetlands data has been provided by Stantec dated August 29, 2014. Freshwater Atlas wetlands outside of construction corridor have been removed from scenery.
- Cutblock data is confirmed using information from the Government of BC websites for Forest MapView and MapBC.
- This pipeline section is partially within the Agricultural Land Reserve.
- Field Survey Completed July 15, 2014.
- This plan represents the best information available at the time of survey. Focus Surveys and its employees take no responsibility for the location of any underground conduits, pipes, or other facilities whether shown on or omitted from this plan. All underground installations should be located by the respective authorities prior to construction.

LEGEND
Proposed Pipeline R/W shown thus:
Proposed Temp. Workspaces shown thus:
Proposed Log Decks & Storage Sites shown thus:
Right of Way shown thus:
Roads shown thus:
Highway shown thus:
Railway line shown thus:
Seismic line/trail shown thus:
Recreation Tenure shown thus:
Drainages shown thus:
Buried cable shown thus:
Buried pipe shown thus:
Overhead powerline shown thus:
Riparian Reserve Zone shown thus:
Forest Cover Reserve shown thus:
Archaeological site shown thus:
Agricultural Land Reserve body shown thus:
Coal Tenure body shown thus:
Cutblock body shown thus:
Fence body shown thus:
Fish/Wildlife Reserve body shown thus:
Grazing Tenure body shown thus:
Mineral Claim body shown thus:
Tree Farm Licence shown thus:
Quarry Reserve body shown thus:
Ungulate Winter Range body shown thus:
Visual Land Inventory shown thus:
Watershed Reserve body shown thus:
Wind Tenure body shown thus:
Woodlot body shown thus:
Fault Line shown thus:
Misc. Reserve/Notation body shown thus:
Misc. Licence/Permit body shown thus:
Stantec Wetland / Classification shown thus:
Crossings shown thus:
Old Growth Management Area shown thus:
Residences shown thus:
Nisga'a Lands shown thus:
Nisga'a Village Lands shown thus:
Lava Bed Park shown thus:

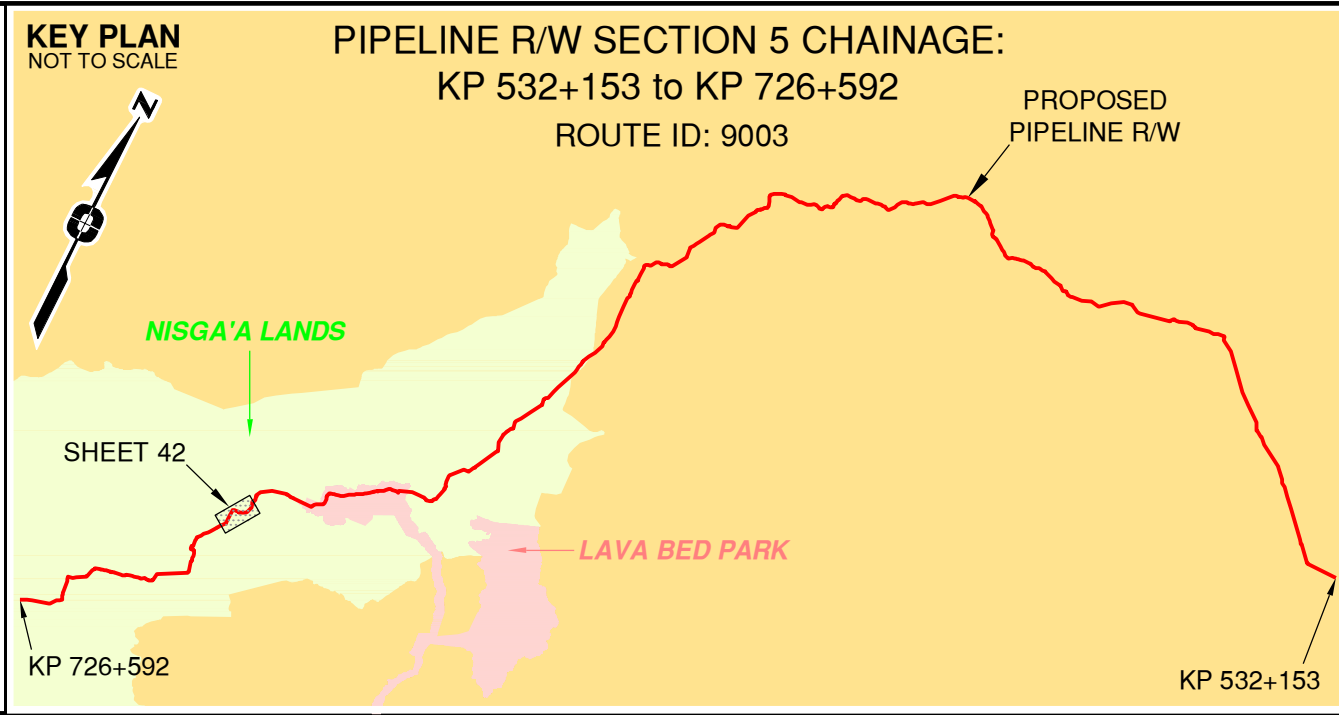

APPROVED BY
PROJECT ENGINEER

No.	STATION	DESCRIPTION	NAD 83 UTM ZONE 9	OWNER
W02025	(S1) 697+793	Trib to Ansedagan Creek / S4 / RRZ=0 RMZ=30	N 6108408 E 477019	ILMB
W02024	(S1) 697+738	Trib to Nass River / S6 / RRZ=0 RMZ=20	N 6108463 E 477023	ILMB
W02023	(S1) 697+667	Trib to Nass River / S4 / RRZ=0 RMZ=30	N 6108534 E 477027	ILMB
T01020	(S1) 696+743	Trail / Condition Unknown	N 6109455 E 477091	Nisga'a Lisims Government
T00736	(S1) 696+590	Forestry Road / LGGR / R12576 A (Retired)	N 6109608 E 477105	Nisga'a Lisims Government
W02630	(S1) 696+539	Trib to Ansedagan Creek / S4 / RRZ=0 RMZ=30	N 6109659 E 477110	ILMB
W02022	(S1) 696+449	Ansedagan Creek / S2 / RRZ=30 RMZ=20	N 6109748 E 477119	ILMB
W02017	(S1) 694+800	Trib to Ansedagan Creek / No visible channel / RRZ=0 RMZ=0	N 6110197 E 478571	ILMB
T00604	(S1) 693+981	Trail / Condition Unknown	N 6110935 E 478870	Nisga'a Lisims Government
T00603	(S1) 693+944	Trail / Condition Unknown	N 6110970 E 478858	Nisga'a Lisims Government

Prince Rupert Gas Transmission Project

TransCanada  
In business to deliver

**PRINCE RUPERT GAS TRANSMISSION LTD.**

PROPOSED VARIABLE WIDTH (32 to 90m) PIPELINE R/W FROM d-59-I, 93-M-5 TO c-71-D, 103-P-3 (S1), c-71-D TO d-63-D, 103-P-3 (S2 & S3) & FROM d-63-D, 103-P-3 TO a-71-J, 103-I-13 (S4) (SHEET CHAINAGE: 693+864 TO 698+268)

Unsurveyed Crown Land/Crown Land/Private Land/Nisga'a Lands & Village Lands/Lava Bed Park Cassiar District & Range 5 Coast District

100 200 300 400

The intended plot size of this plan is 864mm in width by 560mm in height when plotted at a scale of 1: 5000 (use D size sheet)

BCGS: 1031.092/93.93M.042/51/52/61.103P.00304/14/15/25/26/36/46/56/67/68/69/70

Sheet 42 of 49

**FOCUS**  
Focus Surveys (BC) Limited Partnership  
10710 - 100th Avenue Fort St. John BC  
V1J 1Z3 250.757.0300 www.focus.ca

FOCUS: 130275CP05R1  
AFCE: 5005948  
TCPL: 004776-09-ML-03-178  
ePASS: 10048852

REV. 1





Rev	Revision Description	Date(Y/M/D)	By
0	Original Plan Prepared	2014/09/19	DC
1	Construction Plan Based on Rev.0 (2014/09/12) Except for New Construction Corridor: Shape, Label, Area Table & ePass Corrected Area on (S1)	2014/12/31	DC

NOTES:

- Co-ordinates are NAD 83 Grid, UTM Zone 9 and Zone 10. Distances shown are in metres and decimals thereof. Chainages are two-dimensional and are on pipeline ditchline. Pipeline segment length derived from ditchline chainages.
- Fault Lines data has been provided from BGC Engineering Inc. Desktop Study dated December 20, 2013.
- Water crossing information has been provided by Stantec. Wetlands data has been provided by Stantec dated August 29, 2014. Freshwater Atlas wetlands outside of construction corridor have been removed from scenery.
- Cutblock data is confirmed using information from the Government of BC websites for Forest MapView and MapBC.
- This pipeline section is partially within the Agricultural Land Reserve.
- Field Survey Completed July 15, 2014.
- This plan represents the best information available at the time of survey. Focus Surveys and its employees take no responsibility for the location of any underground conduits, pipes, or other facilities whether shown on or omitted from this plan. All underground installations should be located by the respective authorities prior to construction.

LEGEND
Proposed Pipeline R/W shown thus:
Proposed Temp. Workspaces shown thus:
Proposed Log Decks & Storage Sites shown thus:
Right of Way shown thus:
Roads shown thus:
Highway shown thus:
Railway line shown thus:
Seismic line/trail shown thus:
Recreation Tenure shown thus:
Drainages shown thus:
Buried cable shown thus:
Buried pipe shown thus:
Overhead powerline shown thus:
Riparian Reserve Zone shown thus:
Forest Cover Reserve shown thus:
Archaeological site shown thus:
Agricultural Land Reserve shown thus:
Coal Tenure body shown thus:
Cutblock body shown thus:
Fence body shown thus:
Fish/Wildlife Reserve body shown thus:
Grazing Tenure body shown thus:
Mineral Claim body shown thus:
Tree Farm Licence shown thus:
Quarry Reserve body shown thus:
Ungulate Winter Range body shown thus:
Visual Land Inventory shown thus:
Watershed Reserve body shown thus:
Wind Tenure body shown thus:
Woodlot body shown thus:
Fault Line shown thus:
Misc. Reserve/Notation body shown thus:
Misc. Licence/Permit body shown thus:
Stantec Wetland / Classification shown thus:
Crossings shown thus:
Old Growth Management Area shown thus:
Residences shown thus:
Nisga'a Village Lands shown thus:
Lava Bed Park shown thus:

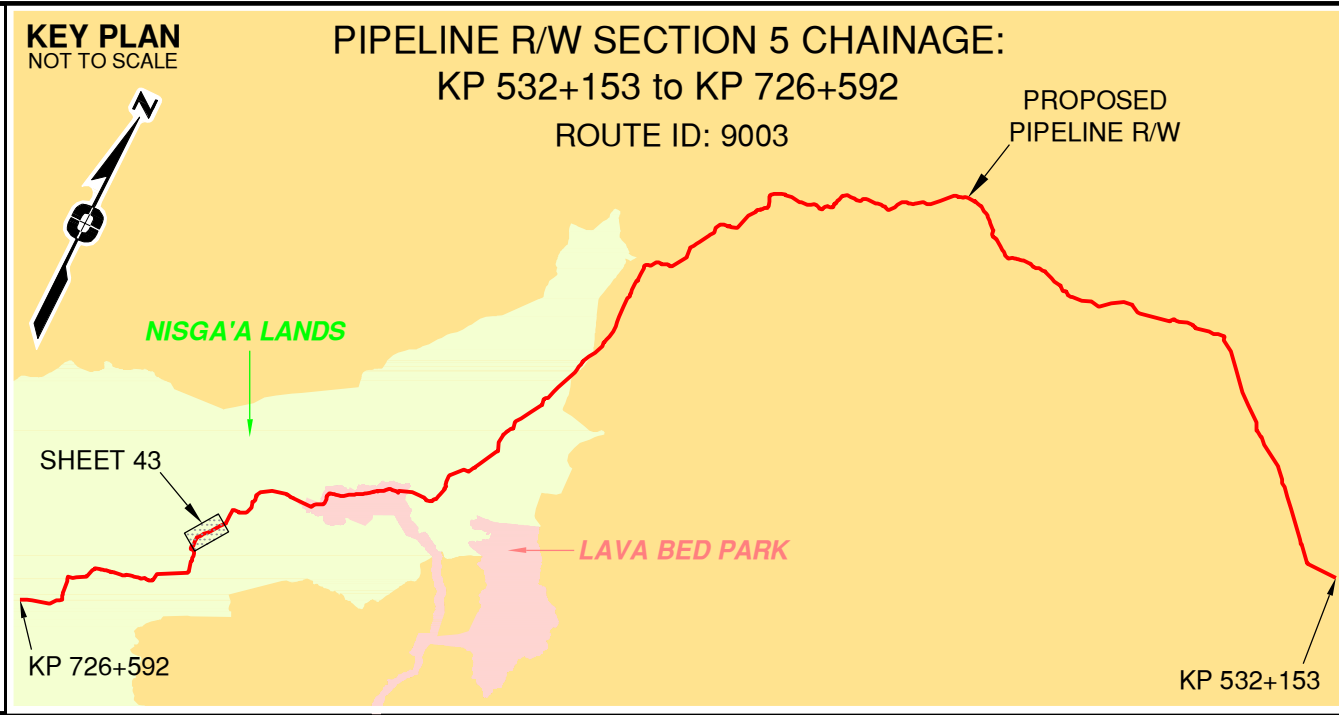

APPROVED BY
PROJECT ENGINEER

No.	STATION	DESCRIPTION	OWNER
W02032	(S1) 701+919	Kseemamath Creek / S1 / RRZ=50 RMZ=20	N 6105209 E 474664
T00609	(S1) 701+733	Forestry Road / LGGR / R07817 A	N 6105394 E 474665
W02031	(S1) 701+607	Trib to Kseemamath Crk / Non-classified drain / RRZ=0 RMZ=0	N 6105520 E 474669
T00608	(S1) 701+468	Trail / Condition Unknown	N 6105658 E 474662
W02030	(S1) 699+926	Trib to Nass River / Non-classified drainage / RRZ=0 RMZ=0	N 6106780 E 475698
W02756	(S1) 699+730	Trib to Nass River / S4 / RRZ=0 RMZ=30	N 6106921 E 475834
W02757	(S1) 699+673	Trib to Nass River / S4 / RRZ=0 RMZ=30	N 6106965 E 475869
T01029	(S1) 699+445	Trail / Condition Unknown	N 6107142 E 476013
W02029	(S1) 699+221	Trib to Nass River / S4 / RRZ=0 RMZ=30	N 6107315 E 476155
W02758	(S1) 699+095	Trib to Nass River / S4 / RRZ=0 RMZ=30	N 6107415 E 476231
W02759	(S1) 698+952	Trib to Nass River / S4 / RRZ=0 RMZ=30	N 6107537 E 476305
W02028	(S1) 698+473	Trib to Nass River / S6 / RRZ=0 RMZ=20	N 6107876 E 476464
W02027	(S1) 698+420	Trib to Nass River / S4 / RRZ=0 RMZ=30	N 6107913 E 476682
W02026	(S1) 698+298	Trib to Nass River / S4 / RRZ=0 RMZ=30	N 6107999 E 476768

Prince Rupert Gas Transmission Project

**PRINCE RUPERT GAS TRANSMISSION LTD.**

PROPOSED VARIABLE WIDTH (32 to 90m) PIPELINE R/W FROM d-59-I, 93-M-5 TO c-71-D, 103-P-3 (S1), c-71-D TO d-63-D, 103-P-3 (S2 & S3) & FROM d-63-D, 103-P-3 TO a-71-J, 103-I-13 (S4) (SHEET CHAINAGE: 698+268 TO 702+199)

Unsurveyed Crown Land/Crown Land/Private Land/Nisga'a Lands & Village Lands/Lava Bed Park

Cassiar District & Range 5 Coast District

BCGS: 1031.092/93.93M.042/51/52/61, 103P.003/04/14/15/25/26/36/46/56/57/67/68/69/70

The intended plot size of this plan is 864mm in width by 560mm in height when plotted at a scale of 1: 5000 (use D size sheet)

Sheet 43 of 49

**FOCUS**  
Focus Surveys (BC) Limited Partnership  
10716 - 100th Avenue Fort St. John BC  
V1J 1Z3 250.757.0300 www.focus.ca

**FOCUS:**  
AFE: 130275CP05R1  
TCPL: 004776-09-ML-03-179  
ePASS: 10048852

**REV.**  
1





Rev	Revision Description	Date(Y/M/D)	By
0	Original Plan Prepared	2014/09/19	DC
1	Construction Plan Based on Rev.0 (2014/09/12) Except for New Construction Corridor: Shape, Label, Area Table & ePass Corrected Area on (S1)	2014/12/31	DC

NOTES:

- Co-ordinates are NAD 83 Grid, UTM Zone 9 and Zone 10. Distances shown are in metres and decimals thereof. Chainages are two-dimensional and are on pipeline ditchline. Pipeline segment length derived from ditchline chainages.
- Fault Lines data has been provided from BGC Engineering Inc. Desktop Study dated December 20, 2013.
- Water crossing information has been provided by Stantec. Wetlands data has been provided by Stantec dated August 29, 2014. Freshwater Atlas wetlands outside of construction corridor have been removed from scenery.
- Cutblock data is confirmed using information from the Government of BC websites for Forest Map View and MapBC.
- This pipeline section is partially within the Agricultural Land Reserve.
- Field Survey Completed July 15, 2014.
- This plan represents the best information available at the time of survey. Focus Surveys and its employees take no responsibility for the location of any underground conduits, pipes, or other facilities whether shown on or omitted from this plan. All underground installations should be located by the respective authorities prior to construction.

LEGEND
Proposed Pipeline R/W shown thus:
Proposed Temp. Workspaces shown thus:
Proposed Log Decks & Storage Sites shown thus:
Right of Way shown thus:
Roads shown thus:
Highway shown thus:
Railway line shown thus:
Seismic line/trail shown thus:
Recreation Tenure shown thus:
Drainages shown thus:
Buried cable shown thus:
Buried pipe shown thus:
Overhead powerline shown thus:
Riparian Reserve Zone shown thus:
Forest Cover Reserve shown thus:
Archaeological site shown thus:
Agricultural Land Reserve shown thus:
Coal Tenure body shown thus:
Cutblock body shown thus:
Fence body shown thus:
Fish/Wildlife Reserve body shown thus:
Grazing Tenure body shown thus:
Mineral Claim body shown thus:
Tree Farm Licence shown thus:
Quarry Reserve body shown thus:
Ungulate Winter Range body shown thus:
Visual Land Inventory shown thus:
Watershed Reserve body shown thus:
Wind Tenure body shown thus:
Woodlot body shown thus:
Fault Line shown thus:
Misc. Reserve/Notation body shown thus:
Misc. Licence/Permit body shown thus:
Stantec Wetland / Classification shown thus:
Crossings shown thus:
Old Growth Management Area shown thus:
Residences shown thus:
Nisga'a Village Lands shown thus:
Lava Bed Park shown thus:

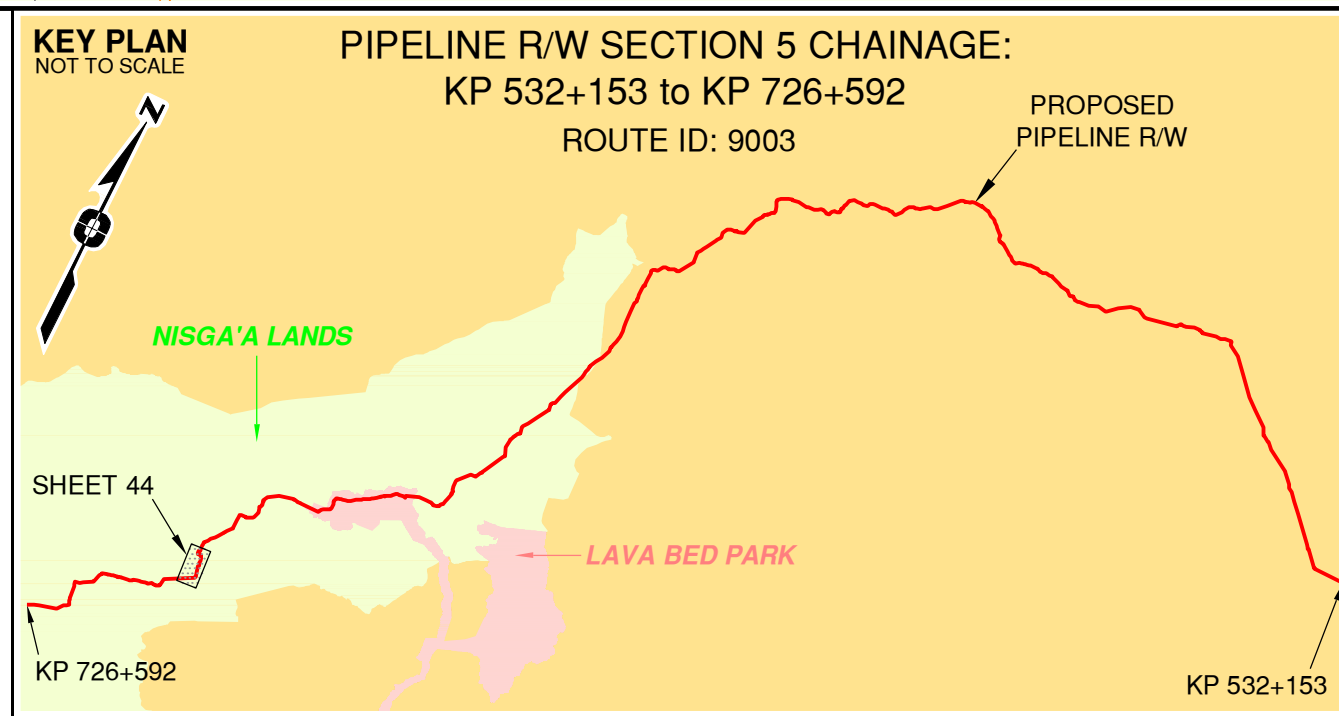

APPROVED BY

PROJECT ENGINEER

No.	STATION	DESCRIPTION	NAD 83 UTM ZONE 9	OWNER
W02753	(S4) 707+250	Trib to Ksi Mat'in River / S4 / RRZ=0 RMZ=30	N 6101267 E 473846	ILMB
W02037	(S3) 706+219	Trib to Ksi Mat'in River / S5 / RRZ=0 RMZ=30	N 6101294 E 474244	ILMB
W02039	(S3) 706+846	Trib to Ksi Mat'in River / S6 / RRZ=0 RMZ=20	N 6101247 E 474493	ILMB
T00617	(S3) 706+802	Trail / Condition Unknown	N 6101240 E 474535	Nisga'a Lisims Government
W02038	(S3) 706+463	Ksi Mat'in River / S1A / RRZ=50 RMZ=20	N 6101322 E 474848	ILMB
T00616	(S3) 706+344	Forestry Road R12574 A (Retired) / Condition Unknown	N 6101378 E 474961	Nisga'a Lisims Government
T00615	(S3) 706+266	Road / Condition Unknown	N 6101437 E 474994	Nisga'a Lisims Government
W02037	(S3) 706+219	Trib to Ksi Mat'in River / S5 / RRZ=0 RMZ=30	N 6101480 E 475012	ILMB
W02984	(S2) 706+676	Trib to Ksi Mat'in River / S6 / RRZ=0 RMZ=30	N 6101506 E 474369	ILMB
T00617	(S3) 706+544	Trail / Condition Unknown	N 6101561 E 474489	Nisga'a Lisims Government
W02985	(S2) 706+422	Ksi Mat'in River / S1A / RRZ=50 RMZ=50	N 6101612 E 474600	ILMB
T00616	(S2) 706+181	Forestry Road R12574 A (Retired) / Condition Unknown	N 6101712 E 474819	Nisga'a Lisims Government
T00615	(S2) 706+100	Road / Condition Unknown	N 6101745 E 474892	Nisga'a Lisims Government
T00614	(S1) 705+724	Forestry Road R12574 A (Retired) / Condition Unknown	N 6101935 E 475207	Nisga'a Lisims Government
W02754	(S1) 705+524	Trib to Ksi Mat'in River / S4 / RRZ=0 RMZ=30	N 6101225 E 475256	ILMB
W02755	(S1) 705+181	Trib to Ksi Mat'in River / S4 / RRZ=0 RMZ=30	N 6102464 E 475201	ILMB
W02036	(S1) 704+439	Trib to Ksi Mat'in River / S3 / RRZ=20 RMZ=20	N 6103179 E 475092	ILMB
W02035	(S1) 703+900	Trib to Ksi Mat'in River / S3 / RRZ=20 RMZ=20	N 6103679 E 475080	ILMB
W02034	(S1) 703+821	Trib to Ksi Mat'in River / S3 / RRZ=20 RMZ=20	N 6103757 E 475081	ILMB
T00852	(S1) 703+521	Trail / Condition Unknown	N 6104049 E 475017	Nisga'a Lisims Government
W02033	(S1) 703+328	Trib to Ksi Mat'in River / RRZ=0 RMZ=30	N 6104226 E 474938	ILMB
T00611	(S1) 702+969	Forestry Road / LGGR / R12574 A (Retired)	N 6104316 E 474642	Nisga'a Lisims Government
T00610	(S1) 702+446	Forestry Road / LGGR / R12574 A (Retired)	N 6104709 E 474603	Nisga'a Lisims Government
T00735	(S1) 702+208	Trail / Condition Unknown	N 6104921 E 474675	Nisga'a Lisims Government

Prince Rupert Gas Transmission Project

TransCanada  
In business to deliver

**PRINCE RUPERT GAS TRANSMISSION LTD.**

PROPOSED VARIABLE WIDTH (32 to 90m) PIPELINE R/W FROM d-59-I, 93-M-5 TO c-71-D, 103-P-3 (S1), c-71-D TO d-63-D, 103-P-3 (S2 & S3) & FROM d-63-D, 103-P-3 TO a-71-J, 103-I-13 (S4) (SHEET CHAINAGE: 702+199 TO 707+445)

Unsurveyed Crown Land/Crown Land/Private Land/Nisga'a Lands & Village Lands/Lava Bed Park Cassiar District & Range 5 Coast District

The intended plot size of this plan is 864mm in width by 560mm in height when plotted at a scale of 1: 5000 (use D size sheet)

BCGS: 1031-092/93, 93M, 042/51/52/61, 103P, 003/04/14/15/25/26/46/46/56/57/67/68/69/70

Sheet 44 of 49

**FOCUS**  
Focus Surveys (BC) Limited Partnership  
10710 - 100th Avenue Fort St John BC  
V1J 1Z3 250.787.0300 www.focus.ca

FOCUS: 130275CP05R1  
AFCL: 5005948  
TAPL: 004776-09-ML-03-180  
ePASS: 10048852

REV. 1



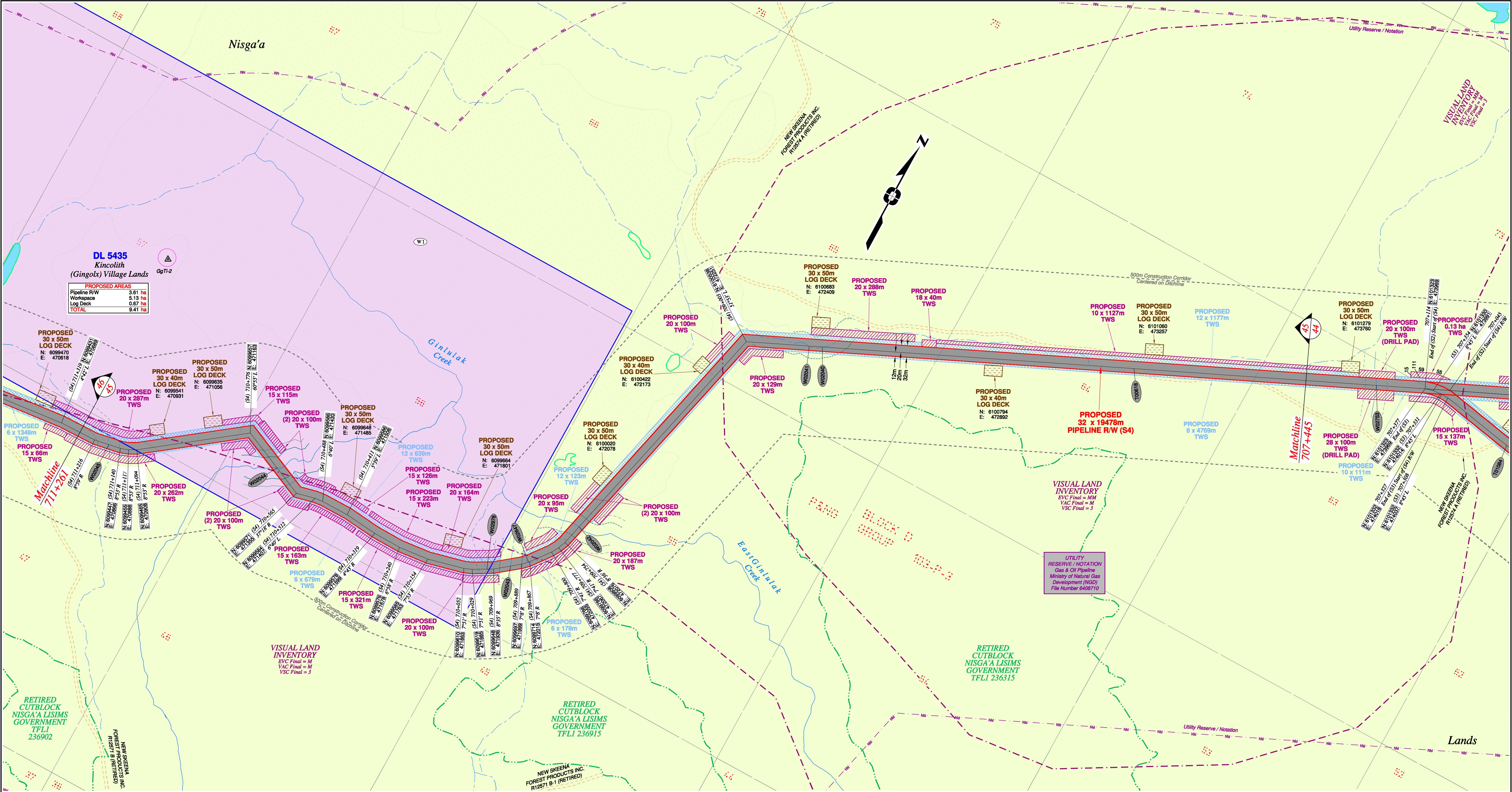

Rev	Revision Description	Date(Y/M/D)	By
0	Original Plan Prepared	2014/09/19	DC
1	Construction Plan Based on Rev.0 (2014/09/12) Except for New Construction Corridor: Shape, Label, Area Table & ePass Corrected Area on (S1)	2014/12/31	DC

NOTES:

- Co-ordinates are NAD 83 Grid, UTM Zone 9 and Zone 10. Distances shown are in metres and decimals thereof. Chainages are two-dimensional and are on pipeline ditchline. Pipeline segment length derived from ditchline chainages.
- Fault Lines data has been provided from BGC Engineering Inc. Desktop Study dated December 20, 2013.
- Water crossing information has been provided by Stantec. Wetlands data has been provided by Stantec dated August 29, 2014. Freshwater Atlas wetlands outside of construction corridor have been removed from scenery.
- Cutblock data is confirmed using information from the Government of BC websites for Forest MapView and MapBC.
- This pipeline section is partially within the Agricultural Land Reserve.
- Field Survey Completed July 15, 2014
- This plan represents the best information available at the time of survey. Focus Surveys and its employees take no responsibility for the location of any underground conduits, pipes, or other facilities whether shown on or omitted from this plan. All underground installations should be located by the respective authorities prior to construction.

LEGEND
Proposed Pipeline R/W shown thus:
Proposed Temp. Workspaces shown thus:
Proposed Log Decks & Storage Sites shown thus:
Right of Way shown thus:
Roads shown thus:
Highway shown thus:
Railway line shown thus:
Seismic line/trail shown thus:
Recreation Tenure shown thus:
Drainages shown thus:
Buried cable shown thus:
Buried pipe shown thus:
Overhead powerline shown thus:
Riparian Reserve Zone shown thus:
Riparian Management Zone shown thus:
Forest Cover Reserve shown thus:
Archaeological site shown thus:
Agricultural Land Reserve body shown thus:
Coal Tenure body shown thus:
Cutblock body shown thus:
Fence body shown thus:
Fish/Wildlife Reserve body shown thus:
Grazing Tenure body shown thus:
Mineral Claim body shown thus:
Tree Farm Licence shown thus:
Quarry Reserve body shown thus:
Ungulate Winter Range body shown thus:
Visual Land Inventory shown thus:
Watershed Reserve body shown thus:
Wind Tenure body shown thus:
Woodlot body shown thus:
Fault Line shown thus:
Misc. Reserve/Notation body shown thus:
Misc. Licence/Permit body shown thus:
Stantec Wetland / Classification shown thus:
Crossings shown thus:
Old Growth Management Area shown thus:
Residences shown thus:
Nisga'a Lands shown thus:
Nisga'a Village Lands shown thus:
Lava Bed Park shown thus:

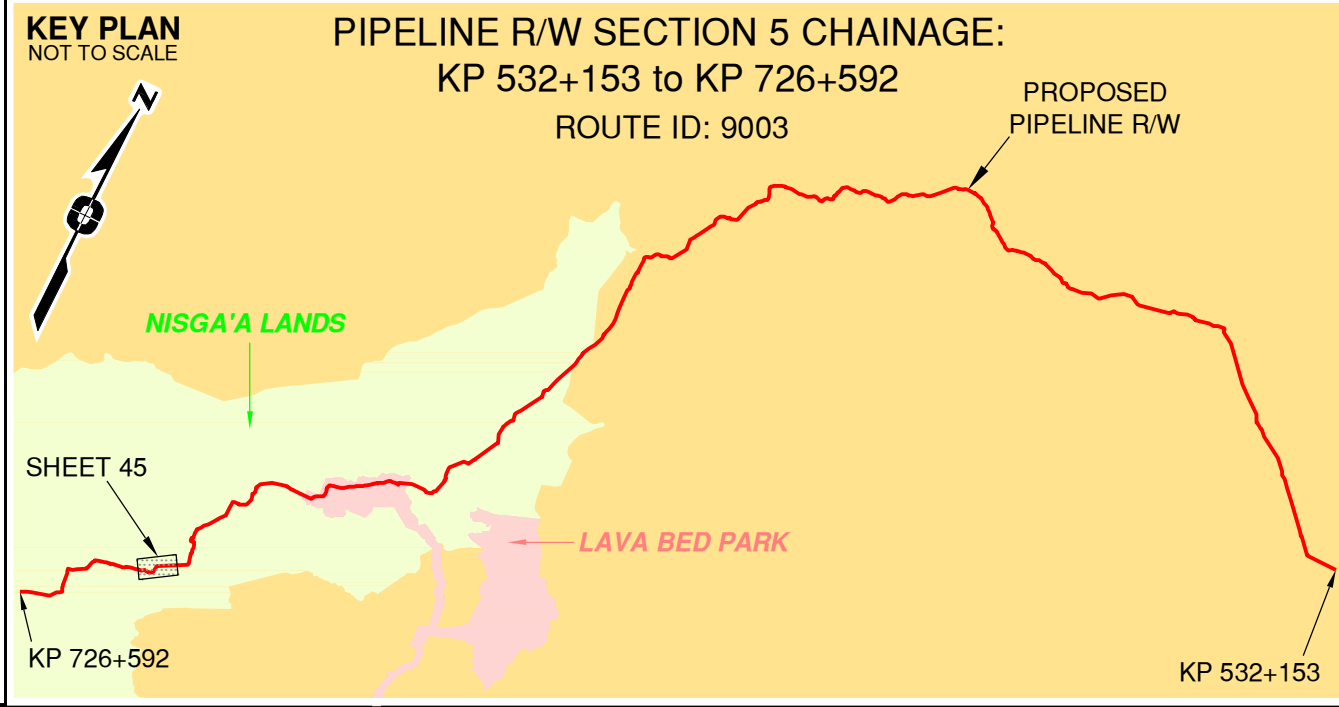

APPROVED BY
PROJECT ENGINEER

No.	STATION	DESCRIPTION	OWNER
W02045	(S4) 711+175	Trib to Ginulak Creek / S4 / RRZ=0 RMZ=30	N 6099441 E 470833 ILMB
W02044	(S4) 710+655	Ginulak Creek / S2 / RRZ=0 RMZ=20	N 6099607 E 471274 ILMB
W02978	(S4) 709+988	Trib to East Ginulak Creek / S6 / RRZ=0 RMZ=20	N 6099639 E 471920 ILMB
W02043	(S4) 709+922	Trib to East Ginulak Creek / S2 / RRZ=0 RMZ=20	N 6099678 E 471974 ILMB
W02647	(S4) 709+871	Trib to East Ginulak Creek / S6 / RRZ=0 RMZ=20	N 6099711 E 472013 ILMB
W02042	(S4) 709+697	East Ginulak Creek / S2 / RRZ=0 RMZ=20	N 6099864 E 472089 ILMB
W02041	(S4) 708+829	Trib to Nass River / RRZ=0 RMZ=20	N 6100610 E 472411 ILMB
W02040	(S4) 708+792	Trib to Nass River / S4 / RRZ=0 RMZ=30	N 6100626 E 472444 ILMB
T00618	(S4) 707+925	Forestry Road R12597 A (Retired) / Condition Unknown	N 6100987 E 473233 Nisga'a Lisims Government

Prince Rupert Gas Transmission Project

TransCanada  
In business to deliver

**PRINCE RUPERT GAS TRANSMISSION LTD.**

PROPOSED VARIABLE WIDTH (32 to 90m) PIPELINE R/W FROM d-59-I, 93-M-5 TO c-71-D, 103-P-3 (S1), c-71-D TO d-63-D, 103-P-3 (S2 & S3) & FROM d-63-D, 103-P-3 TO a-71-J, 103-I-13 (S4) (SHEET CHAINAGE: 707+445 TO 711+261)

Unsurveyed Crown Land/Crown Land/Private Land/Nisga'a Lands & Village Lands/Lava Bed Park Cassiar District & Range 5 Coast District

BCGS: 1031-092/93, 93M, 042/51/52/61, 103P, 003/04/14/15/25/26/36/46/56/57/67/68/69/70

The intended plot size of this plan is 864mm in width by 560mm in height when plotted at a scale of 1: 5000 (use D size sheet)

Sheet 45 of 49

**FOCUS**  
Focus Surveys (BC) Limited Partnership  
10716 - 100th Avenue Fort St. John BC  
V1J 1Z3 250.787.0300 www.focus.ca

**FOCUS:**  
AFPE: 130275CP05R1  
TCPL: 5005948  
ePASS: 004776-09-ML-03-181  
10048852

REV. 1





Rev	Revision Description	Date(Y/M/D)	By
0	Original Plan Prepared	2014/09/19	DC
1	Construction Plan Based on Rev.0 (2014/09/12) Except for New Construction Corridor: Shape, Label, Area Table & ePass Corrected Area on (S1)	2014/12/31	DC

NOTES:

- Co-ordinates are NAD 83 Grid, UTM Zone 9 and Zone 10. Distances shown are in metres and decimals thereof. Chainages are two-dimensional and are on pipeline ditchline. Pipeline segment length derived from ditchline chainages.
- Fault Lines data has been provided from BGC Engineering Inc. Desktop Study dated December 20, 2013.
- Water crossing information has been provided by Stantec. Wetlands data has been provided by Stantec dated August 29, 2014. Freshwater Atlas wetlands outside of construction corridor have been removed from scenery.
- Cutblock data is confirmed using information from the Government of BC websites for Forest Map/View and MapBC.
- This pipeline section is partially within the Agricultural Land Reserve.
- Field Survey Completed July 15, 2014
- This plan represents the best information available at the time of survey. Focus Surveys and its employees take no responsibility for the location of any underground conduits, pipes, or other facilities whether shown on or omitted from this plan. All underground installations should be located by the respective authorities prior to construction.

LEGEND
Proposed Pipeline R/W shown thus:
Proposed Temp. Workspaces shown thus:
Proposed Log Decks & Storage Sites shown thus:
Right of Way shown thus:
Roads shown thus:
Highway shown thus:
Railway line shown thus:
Seismic line/trail shown thus:
Drainages shown thus:
Buried cable shown thus:
Buried pipe shown thus:
Overhead powerline shown thus:
Riparian Reserve Zone shown thus:
Forest Cover Reserve shown thus:
Archaeological site shown thus:
Agricultural Land Reserve shown thus:
Coal Tenure bdy shown thus:
Fence bdy shown thus:
Fish/Wildlife Reserve bdy shown thus:
Grazing Tenure bdy shown thus:
Mineral Claim bdy shown thus:
Tree Farm Licence shown thus:
Quarry Reserve bdy shown thus:
Ungulate Winter Range bdy shown thus:
Visual Land Inventory shown thus:
Watershed Reserve bdy shown thus:
Woodlot bdy shown thus:
Fault Line shown thus:
Misc. Reserve/Notation bdy shown thus:
Misc. Licence/Permit bdy shown thus:
Stantec Wetland / Classification shown thus:
Crossings shown thus:
Old Growth Management Area shown thus:
Residences shown thus:
Nisga'a Lands shown thus:
Nisga'a Village Lands shown thus:
Lava Bed Park shown thus:

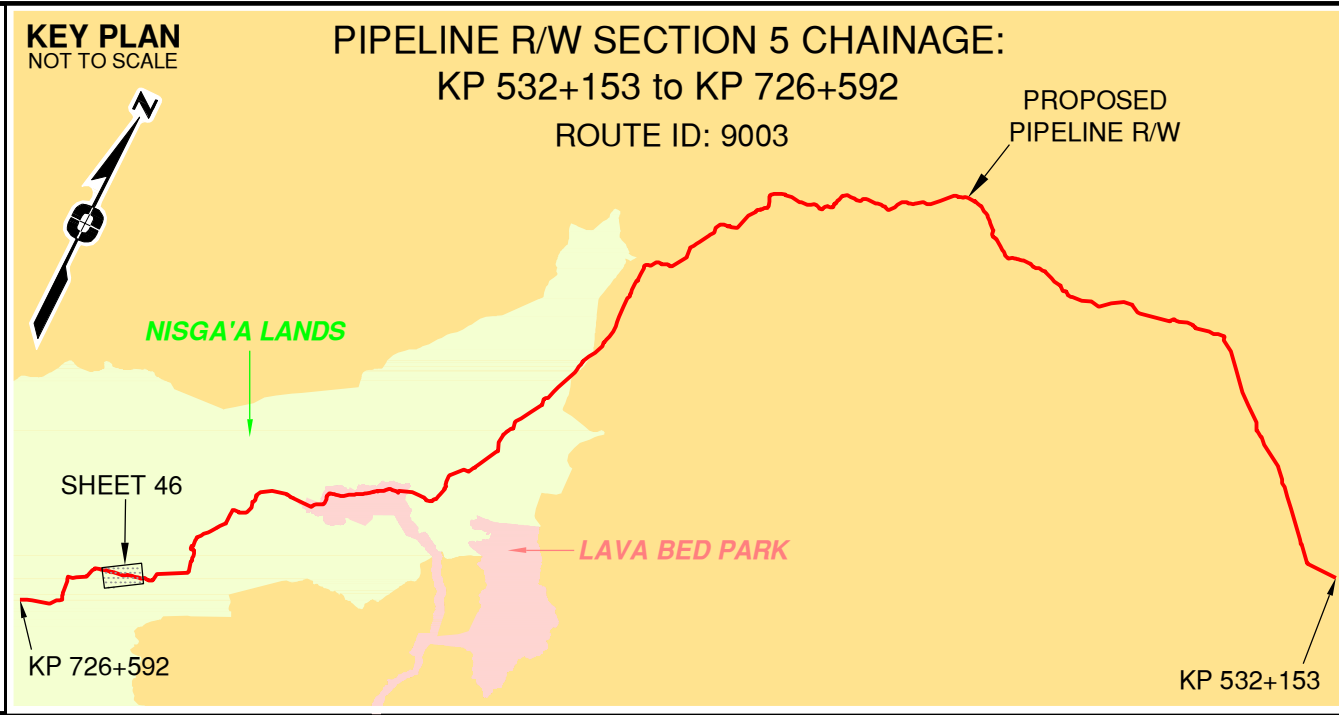

APPROVED BY
PROJECT ENGINEER

No.	STATION	DESCRIPTION	NAD 83 UTM ZONE 9	OWNER
T00885	(S4) 714+754	Trail / Condition Unknown	N 6098864 E 467349	Nisga'a Usims Government
W02752	(S4) 714+498	Trib to Nass River / S6 / RRZ=0 RMZ=20	N 6098884 E 467605	ILMB
W02049	(S4) 713+581	Trib to Nass River / S6 / RRZ=0 RMZ=20	N 6099015 E 468504	ILMB
W02050	(S4) 713+526	Trib to Nass River / S5 / RRZ=0 RMZ=30	N 6099018 E 468558	ILMB
W02048	(S4) 713+386	Trib to Nass River / S5 / RRZ=0 RMZ=30	N 6099025 E 468698	ILMB
W02648	(S4) 712+664	Trib to Ginulak Creek / S4 / RRZ=0 RMZ=30	N 6099231 E 469367	ILMB
W02047	(S4) 712+597	Trib to Ginulak Creek / S2 / RRZ=0 RMZ=20	N 6099253 E 469430	ILMB
T01018	(S4) 712+110	Forestry Road / R12571 B (Retired)	N 6099358 E 469902	Nisga'a Usims Government
W02046	(S4) 711+780	Trib to Ginulak Creek / S6 / RRZ=0 RMZ=20	N 6099382 E 470231	ILMB

Prince Rupert Gas Transmission Project

TransCanada  
In business to deliver

**PRINCE RUPERT GAS TRANSMISSION LTD.**

PROPOSED VARIABLE WIDTH (32 to 90m) PIPELINE R/W FROM d-59-I, 93-M-5 TO c-71-D, 103-P-3 (S1), c-71-D TO d-63-D, 103-P-3 (S2 & S3) & FROM d-63-D, 103-P-3 TO a-71-J, 103-I-13 (S4) (SHEET CHAINAGE: 711+261 TO 715+137)

Unsurveyed Crown Land/Crown Land/Private Land/Nisga'a Lands & Village Lands/Lava Bed Park

Cassiar District & Range 5 Coast District

The intended plot size of this plan is 864mm in width by 560mm in height when plotted at a scale of 1: 5000 (use D size sheet)

BCGS: 1031-092/93.93M.042/51/52/61.103P.003/04/14/15/25/26/36/46/56/57/67/68/69/70

Sheet 46 of 49

**FOCUS**  
Focus Surveys (BC) Limited Partnership  
10710 - 100th Avenue Fort St. John BC  
V1J 1Z3 250.787.0300 www.focus.ca

FOCUS: 130275CP05R1  
AFE: 5005948  
TCPL: 004776-09-ML-03-182  
ePASS: 10048852

REV. 1





Rev	Revision Description	Date(Y/M/D)	By
0	Original Plan Prepared	2014/09/19	DC
1	Construction Plan Based on Rev.0 (2014/09/12) Except for New Construction Corridor: Shape, Label, Area Table & ePass Corrected Area on (S1)	2014/12/31	DC

NOTES:

- Co-ordinates are NAD 83 Grid, UTM Zone 9 and Zone 10. Distances shown are in metres and decimals thereof. Chainages are two-dimensional and are on pipeline ditchline. Pipeline segment length derived from ditchline chainages.
- Fault Lines data has been provided from BGC Engineering Inc. Desktop Study dated December 20, 2013.
- Water crossing information has been provided by Stantec. Wetlands data has been provided by Stantec dated August 29, 2014. Freshwater Atlas wetlands outside of construction corridor have been removed from scenery.
- Cutblock data is confirmed using information from the Government of BC websites for Forest Map/View and MapBC.
- This pipeline section is partially within the Agricultural Land Reserve.
- Field Survey Completed July 15, 2014.
- This plan represents the best information available at the time of survey. Focus Surveys and its employees take no responsibility for the location of any underground conduits, pipes, or other facilities whether shown on or omitted from this plan. All underground installations should be located by the respective authorities prior to construction.

LEGEND
Proposed Pipeline R/W shown thus:
Proposed Temp. Workspaces shown thus:
Proposed Log Decks & Storage Sites shown thus:
Right of Way shown thus:
Roads shown thus:
Highway shown thus:
Railway line shown thus:
Seismic line/trail shown thus:
Recreation Tenure shown thus:
Drainages shown thus:
Buried cable shown thus:
Buried pipe shown thus:
Overhead powerline shown thus:
Riparian Reserve Zone shown thus:
Forest Cover Reserve shown thus:
Archaeological site shown thus:
Agricultural Land Reserve shown thus:
Coal Tenure bdy shown thus:
Cutblock bdy shown thus:
Fence bdy shown thus:
Fish/Wildlife Reserve bdy shown thus:
Grazing Tenure bdy shown thus:
Mineral Claim bdy shown thus:
Tree Farm Licence shown thus:
Quarry Reserve bdy shown thus:
Ungulate Winter Range bdy shown thus:
Visual Land Inventory shown thus:
Watershed Reserve bdy shown thus:
Wind Tenure bdy shown thus:
Woodlot bdy shown thus:
Fault Line shown thus:
Misc. Reserve/Notation bdy shown thus:
Misc. Licence/Permit bdy shown thus:
Stantec Wetland / Classification shown thus:
Crossings shown thus:
Old Growth Management Area shown thus:
Residences shown thus:
Nisga'a Lands shown thus:
Nisga'a Village Lands shown thus:
Lava Bed Park shown thus:

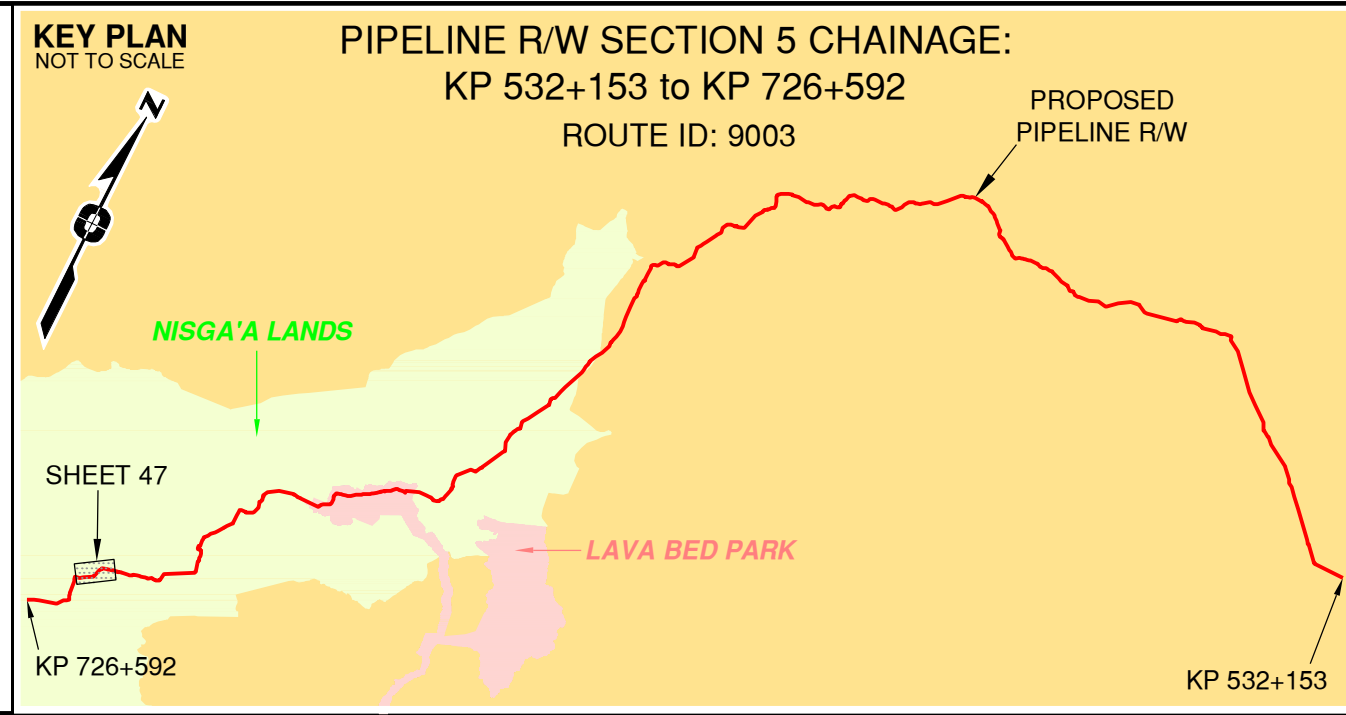

APPROVED BY \_\_\_\_\_

PROJECT ENGINEER \_\_\_\_\_

No.	STATION	DESCRIPTION	NAD 83 UTM ZONE 9	OWNER
W02054	(S4) 719+128	Quilgaun Creek / S1 / RRZ=50 RMZ=20	N 6096741 E 463930	ILMB
W02053	(S4) 718+654	Trib to Quilgaun Creek / S2 / RRZ=30 RMZ=20	N 6096940 E 464350	ILMB
T00882	(S4) 717+072	Trail / Condition Unknown	N 6097838 E 465556	Nisga'a Lisims Government
T00619	(S4) 716+212	Trail / Condition Unknown	N 6098585 E 465945	Nisga'a Lisims Government
W02234	(S4) 716+169	Trib to Nass River / S2 / RRZ=30 RMZ=20	N 6098602 E 465985	ILMB
W02748	(S4) 715+862	Trib to Nass River / Beaver Dam Complex / RRZ=0 RMZ=30	N 6098699 E 466276	ILMB
W02735	(S4) 715+711	Trib to Nass River / S6 / RRZ=0 RMZ=20	N 6098727 E 466422	ILMB
W02750	(S4) 715+681	Trib to Nass River / S6 / RRZ=0 RMZ=20	N 6098718 E 466451	ILMB
W02751	(S4) 715+585	Trib to Nass River / S6 / RRZ=0 RMZ=20	N 6098698 E 466543	ILMB
W02751	(S4) 715+406	Trib to Nass River / S6 / RRZ=0 RMZ=20	N 6098757 E 466712	ILMB
W02051	(S4) 715+188	Trib to Nass River / S3 / RRZ=20 RMZ=20	N 6098819 E 466921	ILMB

Prince Rupert Gas Transmission Project

**PRINCE RUPERT GAS TRANSMISSION LTD.**

PROPOSED VARIABLE WIDTH (32 to 90m) PIPELINE R/W FROM d-59-I, 93-M-5 TO c-71-D, 103-P-3 (S1), c-71-D TO d-63-D, 103-P-3 (S2 & S3) & FROM d-63-D, 103-P-3 TO a-71-J, 103-I-13 (S4) (SHEET CHAINAGE: 715+137 TO 719+241)

Unsurveyed Crown Land/Crown Land/Private Land/Nisga'a Lands & Village Lands/Lava Bed Park Cassiar District & Range 5 Coast District

BCGS: 1031-092/93.93M.042/51/52/61, 103P.003/04/14/15/25/26/36/46/56/67/68/69/70

The intended plot size of this plan is 864mm in width by 560mm in height when plotted at a scale of 1: 5000 (use D size sheet)

Sheet 47 of 49

**FOCUS**  
Focus Surveys (BC) Limited Partnership  
10716 - 100th Avenue, Fort St. John, BC  
V1J 1Z3 250.787.0300 www.focus.ca

**FOCUS:**  
AFE: 130275CP05R1  
TCPL: 5005948  
ePASS: 004776-09-ML-03-183  
10048852

REV. 1



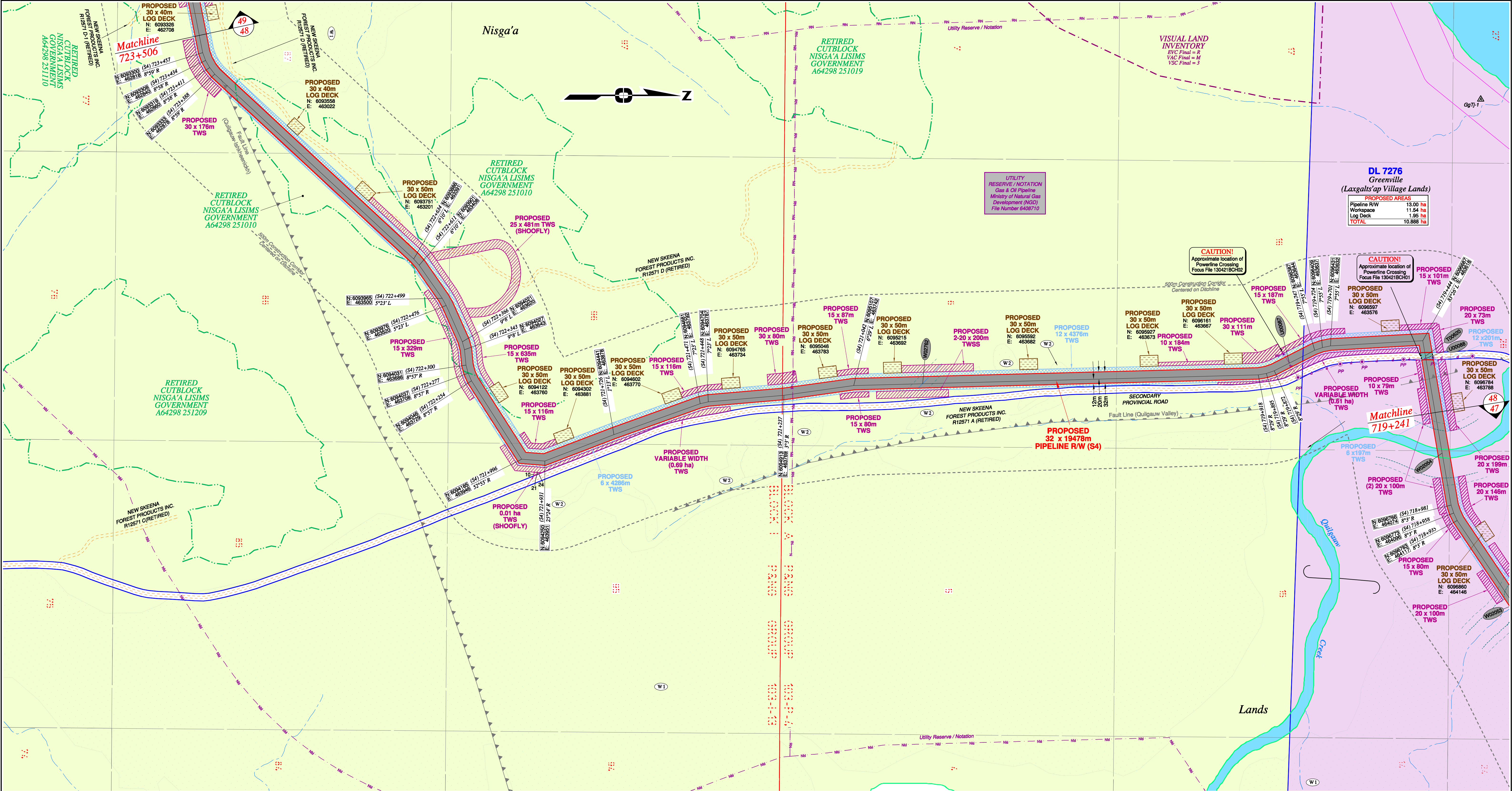

Rev	Revision Description	Date(Y/M/D)	By
0	Original Plan Prepared	2014/09/19	DC
1	Construction Plan Based on Rev.0 (2014/09/12) Except for New Construction Corridor: Shape, Label, Area Table & ePass Corrected Area on (S1)	2014/12/31	DC

NOTES:

- Co-ordinates are NAD 83 Grid, UTM Zone 9 and Zone 10. Distances shown are in metres and decimals thereof. Chainages are two-dimensional and are on pipeline ditchline. Pipeline segment length derived from ditchline chainages.
- Fault Lines data has been provided from BGC Engineering Inc. Desktop Study dated December 20, 2013.
- Water crossing information has been provided by Stantec. Wetlands data has been provided by Stantec dated August 29, 2014. Freshwater Atlas wetlands outside of construction corridor have been removed from scenery.
- Cutblock data is confirmed using information from the Government of BC websites for Forest MapView and MapBC.
- This pipeline section is partially within the Agricultural Land Reserve.
- Field Survey Completed July 15, 2014.
- This plan represents the best information available at the time of survey. Focus Surveys and its employees take no responsibility for the location of any underground conduits, pipes, or other facilities whether shown on or omitted from this plan. All underground installations should be located by the respective authorities prior to construction.

LEGEND
Proposed Pipeline R/W shown thus:
Proposed Temp. Workspaces shown thus: <b>TWS / TWS</b>
Proposed Log Decks & Storage Sites shown thus:
Right of Way shown thus:
Roads shown thus:
Highway shown thus:
Railway line shown thus:
Seismic line/trail shown thus:
Recreation Tenure shown thus:
Drainages shown thus:
Buried cable shown thus:
Buried pipe shown thus:
Overhead powerline shown thus:
Riparian Reserve Zone shown thus:
Forest Cover Reserve shown thus:
Archaeological site shown thus:
Agricultural Land Reserve shown thus:
Coal Tenure bdy shown thus:
Cutblock bdy shown thus:
Fence bdy shown thus:
Fish/Wildlife Reserve bdy shown thus:
Grazing Tenure bdy shown thus:
Mineral Claim bdy shown thus:
Tree Farm Licence shown thus:
Quarry Reserve bdy shown thus:
Ungulate Winter Range bdy shown thus:
Visual Land Inventory shown thus:
Watershed Reserve bdy shown thus:
Wind Tenure bdy shown thus:
Woodlot bdy shown thus:
Fault Line shown thus:
Misc. Reserve/Notation bdy shown thus:
Misc. Licence/Permit bdy shown thus:
Stantec Wetland / Classification shown thus:
Crossings shown thus:
Old Growth Management Area shown thus:
Residences shown thus:
Nisga'a Lands shown thus:
Nisga'a Village Lands shown thus:
Lava Bed Park shown thus:

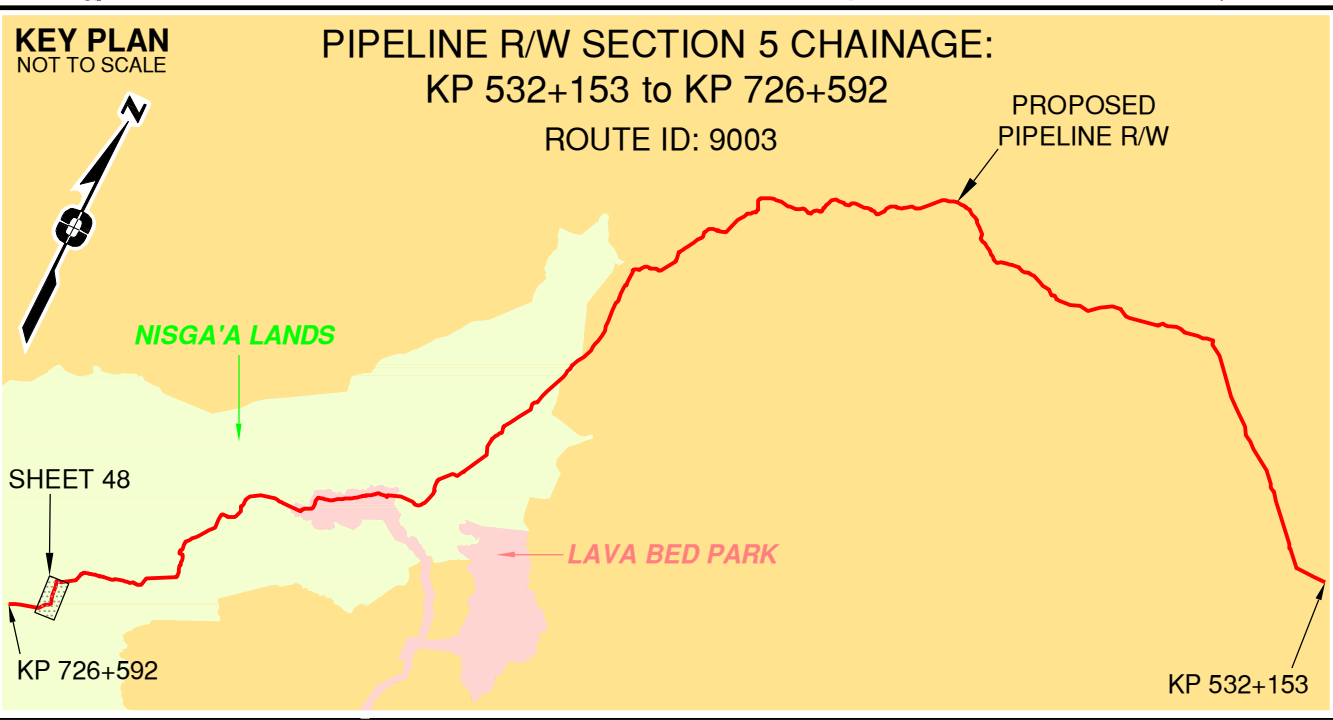

APPROVED BY
PROJECT ENGINEER

No.	STATION	DESCRIPTION	NAD 83 UTM ZONE 9	OWNER
W02762	(S4) 720+851	Trib to Quilgaun Creek / RRZ=0 RMZ=20	N 6095299 E 463737	ILMB
U00087	(S4) 719+826	Overhead Powerline	N 6096317 E 463680	BC Hydro
T00620	(S4) 719+401	Forestry Road / Condition Unknown / R12571 A (Retired)	N 6096695 E 463660	Nisga'a Lisims Government
U00088	(S4) 719+395	Overhead Powerline	N 6096696 E 463667	BC Hydro

TABLE OF CROSSINGS

Prince Rupert Gas Transmission Project

**TransCanada**  
In business to deliver

**PRINCE RUPERT GAS TRANSMISSION LTD.**

PROPOSED VARIABLE WIDTH (32 to 90m) PIPELINE R/W FROM d-59-I, 93-M-5 TO c-71-D, 103-P-3 (S1), c-71-D TO d-63-D, 103-P-3 (S2 & S3) & FROM d-63-D, 103-P-3 TO a-71-J, 103-I-13 (S4) (SHEET CHAINAGE: 719+241 TO 723+506)

Unsurveyed Crown Land/Crown Land/Private Land/Nisga'a Lands & Village Lands/Lava Bed Park/Cassiar District & Range 5 Coast District

The intended plot size of this plan is 864mm in width by 560mm in height when plotted at a scale of 1: 5000 (use D size sheet)

BCGS: 1031.092/93.93M.042/51/52/61, 103P.003/04/14/15/25/26/36/46/56/57/67/68/69/70

Sheet 48 of 49

**FOCUS**  
Focus Surveys (BC) Limited Partnership  
10715 - 100th Avenue, Fort St. John, BC  
V1J 1Z3 250.787.0300 www.focus.ca

FOCUS: 130275CP05R1  
AFE: 5005948  
TCPL: 004776-09-ML-03-184  
ePASS: 10048852

REV. 1





Rev	Revision Description	Date(Y/M/D)	By
0	Original Plan Prepared	2014/09/19	DC
1	Construction Plan Based on Rev.0 (2014/09/12) Except for New Construction Corridor: Shape, Label, Area Table & ePass Corrected Area on (S1)	2014/12/31	DC

NOTES:

- Co-ordinates are NAD 83 Grid, UTM Zone 9 and Zone 10. Distances shown are in metres and decimals thereof. Chainages are two-dimensional and are on pipeline ditchline. Pipeline segment length derived from ditchline chainages.
- Fault Lines data has been provided from BGC Engineering Inc. Desktop Study dated December 20, 2013.
- Water crossing information has been provided by Stantec. Wetlands data has been provided by Stantec dated August 29, 2014. Freshwater Atlas wetlands outside of construction corridor have been removed from scenery.
- Cutblock data is confirmed using information from the Government of BC websites for Forest Map/View and MapBC.
- This pipeline section is partially within the Agricultural Land Reserve.
- Field Survey Completed July 15, 2014
- This plan represents the best information available at the time of survey. Focus Surveys and its employees take no responsibility for the location of any underground conduits, pipes, or other facilities whether shown on or omitted from this plan. All underground installations should be located by the respective authorities prior to construction.

LEGEND
Proposed Pipeline R/W shown thus:
Proposed Temp. Workspaces shown thus:
Proposed Log Decks & Storage Sites shown thus:
Right of Way shown thus:
Roads shown thus:
Highway shown thus:
Railway line shown thus:
Seismic line/trail shown thus:
Recreation Tenure shown thus:
Drainages shown thus:
Buried cable shown thus:
Buried pipe shown thus:
Overhead powerline shown thus:
Riparian Reserve Zone shown thus:
Riparian Management Zone shown thus:
Forest Cover Reserve shown thus:
Archaeological site shown thus:
Agricultural Land Reserve shown thus:
Coal Tenure bdy shown thus:
Cutblock bdy shown thus:
Fence bdy shown thus:
Fish/Wildlife Reserve bdy shown thus:
Grazing Tenure bdy shown thus:
Mineral Claim bdy shown thus:
Tree Farm Licence shown thus:
Quarry Reserve bdy shown thus:
Ungulate Winter Range bdy shown thus:
Visual Land Inventory shown thus:
Watershed Reserve bdy shown thus:
Wind Tenure bdy shown thus:
Woodlot bdy shown thus:
Fault Line shown thus:
Misc. Reserve/Notation bdy shown thus:
Misc. Licence/Permit bdy shown thus:
Stantec Wetland / Classification shown thus:
Crossings shown thus:
Old Growth Management Area shown thus:
Residences shown thus:
Nisga'a Lands shown thus:
Nisga'a Village Lands shown thus:
Lava Bed Park shown thus:
Power Pole shown thus:

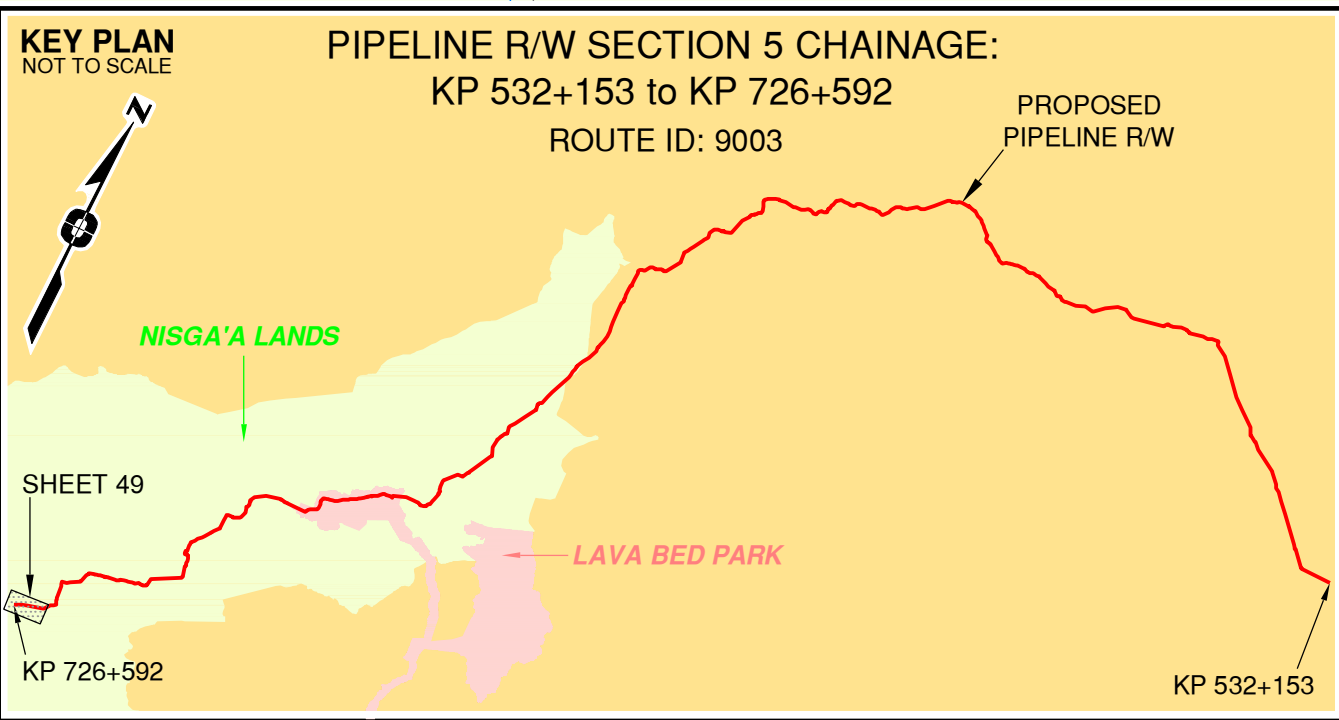

APPROVED BY \_\_\_\_\_

PROJECT ENGINEER \_\_\_\_\_

No.	STATION	DESCRIPTION	NAD 83 UTM ZONE 9	OWNER
W02056	(S4) 725+779	Trib to Ksi Hlginx River / S2 / RR2=30 RMZ=20	N 6092809 E 460550	ILMB
W02634	(S4) 724+957	Trib to Ksi Hlginx River / RR2=0 RMZ=20	N 6093008 E 461347	ILMB
W02633	(S4) 724+863	Trib to Ksi Hlginx River / RR2=0 RMZ=20	N 6093026 E 461439	ILMB
W02057	(S4) 724+678	Ksi Hlginx River / S1 / RR2=50 RMZ=20	N 6093062 E 461621	ILMB
W02632	(S4) 724+506	Trib to Ksi Hlginx River / RR2=0 RMZ=20	N 6093096 E 461790	ILMB
T00622	(S4) 724+130	Trail / Condition Unknown	N 6093169 E 462158	Nisga'a Lisims Government
T00621	(S4) 723+857	Forestry Road / Condition Unknown	N 6093222 E 462427	Nisga'a Lisims Government
T01014	(S4) 723+727	Forestry Road / R12571 D-1 (Retired)	N 6093247 E 462554	Nisga'a Lisims Government
W02055	(S4) 723+718	Trib to Ksi Hlginx River / S5 / RR2=0 RMZ=30	N 6093249 E 462563	ILMB

TABLE OF CROSSINGS

Prince Rupert Gas Transmission Project

**TransCanada**  
In business to deliver

**PRINCE RUPERT GAS TRANSMISSION LTD.**

PROPOSED VARIABLE WIDTH (32 to 90m) PIPELINE R/W FROM d-59-I, 93-M-5 TO c-71-D, 103-P-3 (S1), c-71-D TO d-63-D, 103-P-3 (S2 & S3) & FROM d-63-D, 103-P-3 TO a-71-J, 103-I-13 (S4) (SHEET CHAINAGE: 723+506 TO 726+592)

Unsurveyed Crown Land/Crown Land/Private Land/Nisga'a Lands & Village Lands/Lava Bed Park Cassiar District & Range 5 Coast District

BCGS: 1031.092/93.93M.042/51/52/61, 103P.003/04/14/15/25/26/36/46/56/57/67/68/69/70

The intended plot size of this plan is 864mm in width by 560mm in height when plotted at a scale of 1: 5000 (use D size sheet)

Sheet 49 of 49

**FOCUS**  
Focus Surveys (BC) Limited Partnership  
107110 - 100th Avenue Fort St John BC  
V1J 1Z3 250.787.0300 www.focus.ca

FOCUS: 130275CP05R1  
AFE: 5005948  
TCPL: 004776-09-ML-03-185  
ePASS: 10048852

REV. 1