



June 20, 2016

Pacific Trail Pipelines Management Inc.
c/o Chevron Canada Limited (Attn: Land Department)
500 - Fifth Avenue SW
Calgary, AB T2P 0L7

Attention: Collin Daniels

RE: Road Permit

Date of Issuance: June 20, 2016

Transition of Non-Status Roads to OGAA Road Permit under the implementation of OGRR.

Commission No.: 9644272

Road Permit No.: 04133

Road Name: R-07031-3, R07031-14, R07031-19

PERMISSIONS

1. The BC Oil and Gas Commission ("the Commission"), under section 25 (1) of the *Oil and Gas Activities Act* hereby permits the holder to construct and maintain an oil and gas road, subject to the following conditions:
 - (1) The permissions and authorizations granted by this permit are limited to the area described in plan; CAN-AM FILE: N20150182, CAD FILE: N20150182RT00, Revision 0, dated January 3, 2016 by can-am geomatics bc as submitted to the Commission in the transition application dated April 14, 2016 (hereinafter referenced as the "operating area").
 - (2) Permission to construct is limited to required modifications within the operating area except as otherwise restricted by this permit.
 - (3) Pursuant to Section 138(1) of the *Petroleum and Natural Gas Act*, the permit holder is permitted to enter, occupy and use any unoccupied Crown land located within the operating area to carry out the oil and gas activities authorized under this permit.

CONDITIONS

2. The permit holder will immediately effect, and keep in force while occupying the operating area, insurance of an amount not less than \$1,000,000 protecting the Province, the Commission and the permit holder (without any rights of cross-claim or subrogation) against claims for personal injury, death, property damage, or third party liability claims arising from any accident or occurrence on the operating area.
3. The permission to occupy and use Crown land does not entitle the permit holder to exclusive possession of the area.
4. The rights granted by this permission are subject to all subsisting grants to or rights of any person made or acquired under the *Coal Act, Forest Act, Land Act, Mineral Tenure Act, Petroleum and Natural Gas Act, Range Act, Water Sustainability Act* or *Wildlife Act*, or any extension or renewal of the same.
5. The permit holder must not assign, sublicense or permit any person to use or occupy any Crown land within the operating area, other than its employees, contractors, or representatives, without the Commission's written consent.

6. The permit holder must ensure that any Crown land within the operating area is maintained in a condition so as to minimize hazards, including but not limited to hazards associated with storage of materials and equipment.
7. The permit holder must ensure that any Crown land within the operating area is free of garbage, debris and unused equipment.
8. Following initial construction, stream crossings are authorized for necessary road modification or maintenance activities on the operating area except for
 - (1) construction or replacement of a bridge or major culvert on a S1, S2, S3 or S5 stream;
 - (2) installation of a closed bottom structure in a fish bearing stream; or
 - (3) excavation or grading of a stream bank or stream bed.
9. Stream crossings must be constructed, maintained and deactivated according to the following requirements, as applicable:
 - (1) Only bridges, culverts, ice bridges or snow fills may be constructed at stream crossings;
 - (2) Snow fills must consist of clean snow and may only be located on streams that are dry or frozen to the bottom during the period of construction, maintenance and use. Where periodic thaws are anticipated, culverts must be installed to allow meltwater to pass through. Snow fill and any installed culverts must be removed prior to spring snow melt;
 - (3) Ice bridges on fish bearing streams may only be constructed where sufficient water depth and stream flows prevent the bridge structure from coming in contact with the stream bottom;
 - (4) Water applied to construct an ice bridge on a water body must be sourced in accordance with the *Water Sustainability Act* unless
 - (a) the water body is a stream with a stream channel width of at least 5 metres and is not designated as a sensitive stream under the *Fish Protection Act*, or has a riparian class of W1, W3, or L1,
 - (b) the water is sourced from the same water body proximal to the location on which the ice bridge is constructed,
 - (c) the water body is not within the boundaries of a public park,
 - (d) pump intakes do not disturb beds of streams or wetlands and are screened with a maximum mesh size and approach velocity in accordance with the Fisheries and Oceans Canada Freshwater Intake End-of-Pipe Fish Screen Guideline, and
 - (i) where the water body is a stream, the flow of water in the stream at the time and location of pumping exceeds 60 litres per second and the instantaneous pumping rate does not exceed 1% of the water flowing in the water body at the time and location the pumping occurs, or
 - (ii) where the water body is a lake or pond, the cumulative volume of water withdrawn does not exceed 10 cm of lake or pond depth, calculated as the product of lake or pond surface area x 10 cm;
 - (5) Records of water withdrawal and corresponding streamflow measurements are maintained by the permit holder and provided to the Commission upon request;
 - (6) In-stream activities within a fish bearing stream, lake or wetland must occur:
 - (a) during the applicable reduced risk work windows as specified in the Skeena Region Reduced Risk In-stream Work Windows and Measures,
 - (b) in accordance with alternative timing and associated mitigation recommended by a qualified professional and accepted by the Commission, or

- (c) in accordance with an authorization or letter of advice from Fisheries and Oceans Canada that is provided to the Commission;
 - (7) Bridge or culvert abutments, footings and scour protection must be located outside the natural stream channel and must not constrict the channel width;
 - (8) Equipment used for activities under this authorization must not be situated in a stream channel unless it is dry or frozen to the bottom at the time of the activity.
10. Wetland crossings must be constructed, maintained and removed in accordance with the following:
- (1) Organic cover within and adjacent to the wetland must be retained;
 - (2) Minimize erosion or release of sediment within the wetland;
 - (3) Any padding materials must be placed on the wetland surface only and must not be used for infilling;
 - (4) Any padding materials must be removed as soon as practicable following construction, considering weather and ground conditions; and
 - (5) The wetland, including banks and bed, must be restored, to the extent practicable, to the condition that existed before the crossing was initiated.
11. The permit holder must notify Nee Tahi Buhn Indian Band a minimum of five (5) days prior to commencing any construction activities under this permit.
12. The permit holder must notify Office of the Wet'suwet'en a minimum of five (5) days prior to commencing any construction activities under this permit.
13. The permit holder must notify Skin Tye Nation a minimum of five (5) days prior to commencing any construction activities under this permit.
14. The permit holder must notify Wet'suwet'en First Nation a minimum of five (5) days prior to commencing any construction activities under this permit.

ADVISORY GUIDANCE

- 1. The permit holder must construct, maintain and deactivate the road in accordance with the Oil and Gas Road Regulation.
- 2. The permit holder must not close or restrict the use of the road except as provided for in the Oil and Gas Road Regulation.



Tarilee Rauscher
Authorized Signatory
Commission Delegated Decision Maker

pc: Scott Land Lease Co. Ltd.
Commission File: 9644272

TABLE OF INTERSECTING ROADS				
#	OV'T FILE#	ROAD ID	ROAD NAME	OWNER
1	R07031-1			WEST FRASER MILLS LTD
2	R07031-3			WEST FRASER MILLS LTD
3	R07031-14			WEST FRASER MILLS LTD
4	R07031-15			WEST FRASER MILLS LTD
5	R07031-5			WEST FRASER MILLS LTD
6	R07031-19			WEST FRASER MILLS LTD

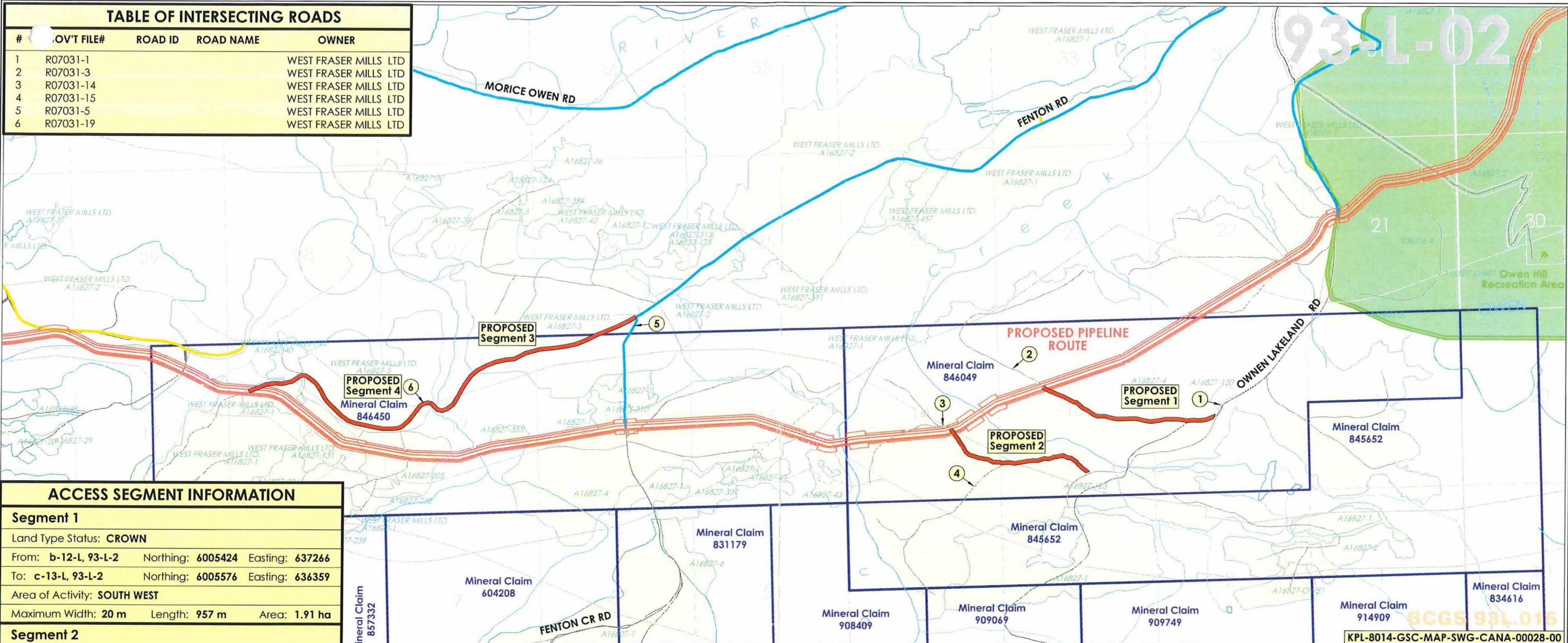

ACCESS SEGMENT INFORMATION			
Segment 1			
Land Type Status: CROWN			
From: b-12-L, 93-L-2	Northing: 6005424	Easting: 637266	
To: c-13-L, 93-L-2	Northing: 6005576	Easting: 636359	
Area of Activity: SOUTH WEST			
Maximum Width: 20 m	Length: 957 m	Area: 1.91 ha	
Segment 2			
Land Type Status: CROWN			
From: a-13-L, 93-L-2	Northing: 6005129	Easting: 636599	
To: a-14-L, 93-L-2	Northing: 6005355	Easting: 635871	
Area of Activity: SOUTH WEST			
Maximum Width: 20 m	Length: 843 m	Area: 1.69 ha	
Segment 3			
Land Type Status: CROWN			
From: a-26-L, 93-L-2	Northing: 6005946	Easting: 634198	
To: c-17-L, 93-L-2	Northing: 6005486	Easting: 633113	
Area of Activity: SOUTH WEST			
Maximum Width: 20 m	Length: 1,261 m	Area: 2.52 ha	
Segment 4			
Land Type Status: CROWN			
From: c-17-L, 93-L-2	Northing: 6005486	Easting: 633113	
To: c-18-L, 93-L-2	Northing: 6005547	Easting: 632152	
Area of Activity: SOUTH WEST			
Maximum Width: 20 m	Length: 1,148 m	Area: 2.30 ha	
Total Area: 8.42 ha	Total Length: 4,209 m		

LEGEND				
Proposed Pipeline Route:				
Current Access Road Route:				
Guide Outfitter Boundaries:				
Trapper Boundaries:				
Range Tenure Boundaries:				
Highway (Paved):				
Road - Existing:				
Road - Public:				
Road - Deactivated:				
Road - Trails and Unused Roads:				
Railway:				
Right of Way:				
Cut Block & Woodlot Boundaries:				
Mineral Claims & Reserves:				
Visual Quality Area:				

Origin of co-ordinates: UTM Zone 9 NAD 83 (CSRS)	
UTM	
N	6005424
E	637266
GEOGRAPHIC	
N	54° 10' 42.56"
W	126° 53' 48.35"
WA No.:	
EPASS:	
FIELD:	
TRAPPER:	
GUIDE/OUTFITTER:	
RANGE TENURE:	
BCGS No.:	93L.016
NTS SHEET:	93-L-2

PACIFIC TRAIL PIPELINES MANAGEMENT INC.

1:20,000 ROAD TRANSITION MAP
b-12-L, 93-L-2 TO c-13-L, 93-L-2 (R07031-3)
a-13-L, 93-L-2 TO c-14-L, 93-L-2 (R07031-14)
a-26-L, 93-L-2 TO c-17-L, 93-L-2 (R07031-19)
c-17-L, 93-L-2 TO c-18-L, 93-L-2
(EAR 299.9-12 TO DO302.2c)

SCALE = 1 : 20,000

200 0 400 800 1200 METRES

can-am geomatics®	CAN-AM FILE: N20150182
can-am geomatics bc Fort Nelson, B.C. www.canam.com	ACAD FILE: N20150182RT00
Phone: 250.774.7881 Toll Free: 1.877.870.7881 Fax: 250.774.7882	Client File No.:
	AFE No.:
	Land File:

REVISION 0

NO.	DATE	REVISION	DRN	CKD
1	16/03/01	Original Plan Issued	Mds	BP