

CROSSING / REFERENCE DRAWINGS				
Crossing No.	Chainage	Owner	Description	NAD 83 UTM Zone 9
1711.00-RD	576+497	CANADIAN FOREST PRODUCTS LTD.	ROAD - PERMITTED ROAD - A16828 739 EM8739 GSNL0012 - LOW GRADE	N=6007577.9, E=589321.9
1712.00-WC	576+662	CROWN	WATER CROSSING - WATERCOURSE - UNNAMED TRIBUTARY TO GOSNELL CREEK - S4* - STANTEC ID NO.: 41D1	N=6007479.6, E=589190.9
1713.00-RD	576+817	CANADIAN FOREST PRODUCTS LTD.	ROAD - PERMITTED ROAD - A16828 739 EM8739 GSNL0012 - LOW GRADE	N=6007386.8, E=589067.2
1714.00-WC	577+014	CROWN	WATER CROSSING - WATERCOURSE - UNNAMED TRIBUTARY TO GOSNELL CREEK - S2 - STANTEC ID NO.: 583B	N=6007269.5, E=588910.8
1715.00-RD	577+178	CROWN	DRAW	N=6007173.4, E=588782.6
1716.00-DR	577+254	CROWN	ROAD - NON-STATUS ROAD - NON-TENURE - TRAIL	N=6007127.6, E=588721.6
1717.00-WC	577+522	CROWN	WATER CROSSING - WATERCOURSE - UNNAMED TRIBUTARY TO GOSNELL CREEK - NON-CLASSIFIED DRAINAGE - STANTEC ID NO.: 584B	N=6006967.0, E=588507.5
1718.00-WC	577+724	CROWN	WATER CROSSING - WATERCOURSE - UNNAMED TRIBUTARY TO GOSNELL CREEK - S3* - STANTEC ID NO.: 585B	N=6006844.5, E=588349.7
1719.00-RD	577+928	CROWN	ROAD - NON-STATUS ROAD - NON-TENURE - TRAIL	N=6006713.7, E=588193.0
1720.00-WC	578+080	CROWN	WATER CROSSING - WATERCOURSE - UNNAMED TRIBUTARY TO GOSNELL CREEK - NON-CLASSIFIED DRAINAGE - STANTEC ID NO.: 586B	N=6006614.4, E=588078.9
1721.00-DR	578+140	CROWN	DRAW	N=6006575.3, E=588034.0
1722.00-DR	578+258	CROWN	DRAW	N=6006498.2, E=587945.4
1723.00-WC	578+415	CROWN	WATER CROSSING - WATERCOURSE - UNNAMED TRIBUTARY TO GOSNELL CREEK - S3* - STANTEC ID NO.: 587B	N=6006395.9, E=587828.0
1724.00-DR	578+767	CROWN	DRAW	N=6006166.9, E=587562.5
1725.00-WC	579+112	CROWN	WATER CROSSING - WATERCOURSE - UNNAMED TRIBUTARY TO GOSNELL CREEK - S4* - STANTEC ID NO.: 588B	N=6005933.5, E=587312.0
1726.00-WC	579+190	CROWN	WATER CROSSING - WATERCOURSE - UNNAMED TRIBUTARY TO GOSNELL CREEK - S6 - STANTEC ID NO.: 588F	N=6005875.5, E=587258.7
1726.00-WC	579+359	CROWN	WATER CROSSING - WATERCOURSE - UNNAMED TRIBUTARY TO GOSNELL CREEK - S4* - STANTEC ID NO.: 588F4	N=6005783.5, E=587145.4

LEGEND:

Proposed Pipeline shown thus:

Buried Pipe shown thus:

Power Pole shown thus:

Overhead Power Line shown thus:

Buried Cable shown thus:

Buried or Overhead Phone Cable shown thus:

Existing Well Site and Access shown thus:

Existing Right-of-Way (R/W) shown thus:

Crown Tenure shown thus:

Center Line of Shoofly / Potential New Road Construction shown thus:

Recreational Trail shown thus:

Non-Status Road shown thus:

MOTI, Permitted and Forest Service Road shown thus:

Numbered Highway shown thus:

Railway shown thus:

Hydrology (TRIM Data) shown thus:

Hydrology (TRIM Data) NCD/NVD shown thus:

Draws shown thus:

Wetlands shown thus:

Riparian Management Zone (RMZ) shown thus:

Riparian Reserve Zone (RRZ) shown thus:

Potential Ancillary Site shown thus:

Fence Line shown thus:

Tree / Bush Line shown thus:

Forest Cut Block / Opening shown thus:

Tree Farm Licence shown thus:

Wildlife Tree Retention shown thus:

Woodlots shown thus:

Parks and Protected Areas shown thus:

Permanent Right-of-Way (R/W) shown thus:

Temporary Workspace (TWS) shown thus:

Log Deck shown thus:

Shoofly Road shown thus:

Laydown shown thus:

Log Storage Site shown thus:

Stockpile Site shown thus:

Alternate Right-of-Way (R/W) shown thus:

Alternate Temporary Work Space (TWS) shown thus:

Alternate Log Deck shown thus:

Pipeline Construction Corridor shown thus:

Range Tenure shown thus:

Old Growth Management Area shown thus:

Agricultural Land Reserve (ALR) shown thus:

Ungulate Winter Range shown thus:

Mineral Claim / Lease shown thus:

Visual Sensitivity Boundary shown thus:

Wildlife Habitat shown thus:

Generic Well Symbol shown thus:

Proposed Block Valve shown thus:

Drawing shown thus:

Pf's shown thus:

Change in Direction of Construction shown thus:

Construction Plan Match Line shown thus:

Alignment Plan Match Line shown thus:

Off Right-of-Way Crossing shown thus:

Preliminary Pipe Profile Chainage shown thus:

BCGS: 93L.012, 93L.013, 93L.014, 93L.015, 93L.016, 93L.017, 93L.018, 93L.022, 93L.023

EPASS No.: 10049409

NOTE: Water Course Crossing Information and New Cut / Existing Cut Information provided to Survey by Coastal GasLink Pipeline Ltd. for the Coastal GasLink Pipeline Project.

NOTE: Refer to Key Plan for Area Table Information.

REVISION / ISSUED				
No.	Date	Description	Drawn By	CKD By
1	OCTOBER 20, 2014	- PLAN ISSUED	K.P.J.C.	R.D./K.L.

NOTE: The information shown on this plan is obtained from various sources including the Government of British Columbia. Information from these sources may change without notice and may not reflect the status as shown on this plan. McElhanney takes no responsibility for the accuracy or completeness of this information, spatially or otherwise.

PROJECT INFORMATION:

THE PROPOSED PROJECT IS:

- To be flagged at time of construction.
- Partially within the Agricultural Land Reserve (ALR)
- Within the South West OGC Zone

NOTE:

- Co-ordinates are UTM Grid NAD 83, Zone 9N. Reference Meridian 129°
- Distances are ground and in metres and decimals thereof

NOTE: Positions of buried facilities shown are derived from interpretations of signals from electronic devices. Reception of electronic signals is subjected to interference and has limitations, therefore it should not be assumed that all buried facilities are shown, and facilities which are shown should not be construed as "located" until physically exposed. All underground installations should be marked by the respective authorities prior to excavation or construction.

British Columbia One Call: 1-800-474-6886

Coastal GasLink Pipeline Project

TransCanada
In business to deliver

COASTAL GASLINK PIPELINE LTD.

CONSTRUCTION PLAN SHOWING
32.0 & 42.0 PIPELINE RIGHT OF WAY
SECTION 7

FROM
UNIT 2, BLOCK I, 93-L-2
TO
UNIT 6, BLOCK J, 93-L-4

THROUGH SURVEYED AND UNSURVEYED CROWN LAND
RANGE 5 COAST DISTRICT

SCALE - 1:5000

16442-08-ML-02-184

Sheet 20 of 21

Route Reference: RevE1

Oct 20, 2014

Document No. CGW4703-MCSL-G-MP-424-020

Rev 0

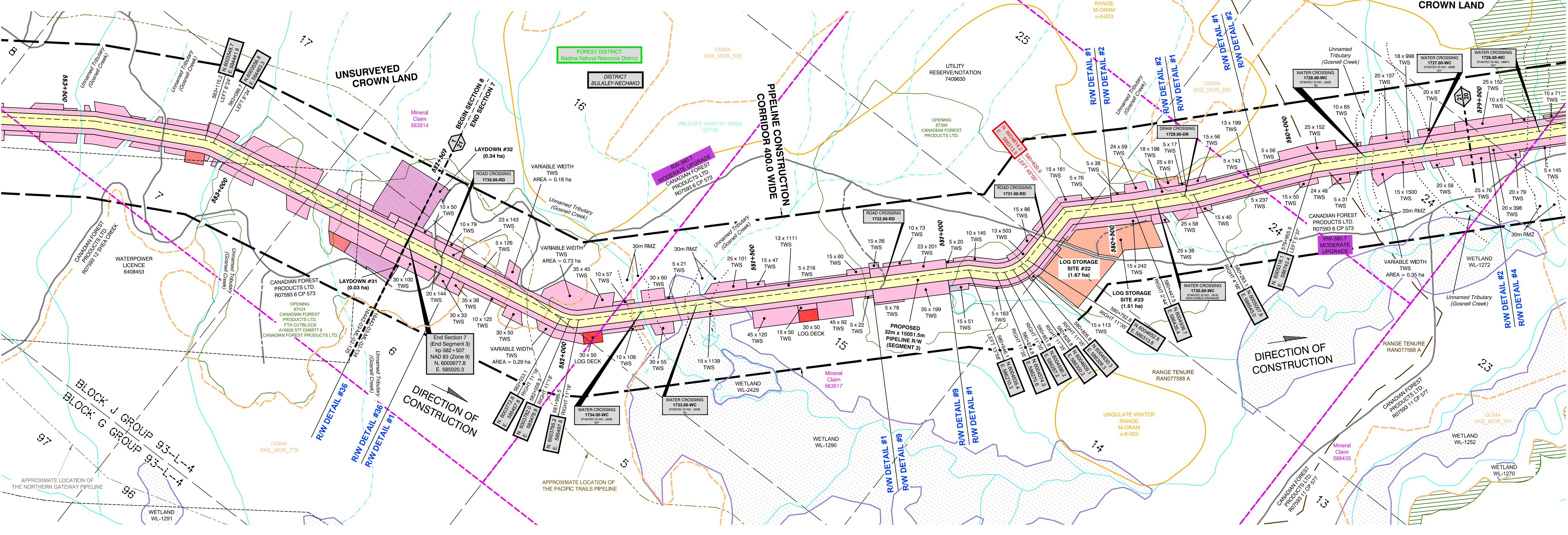
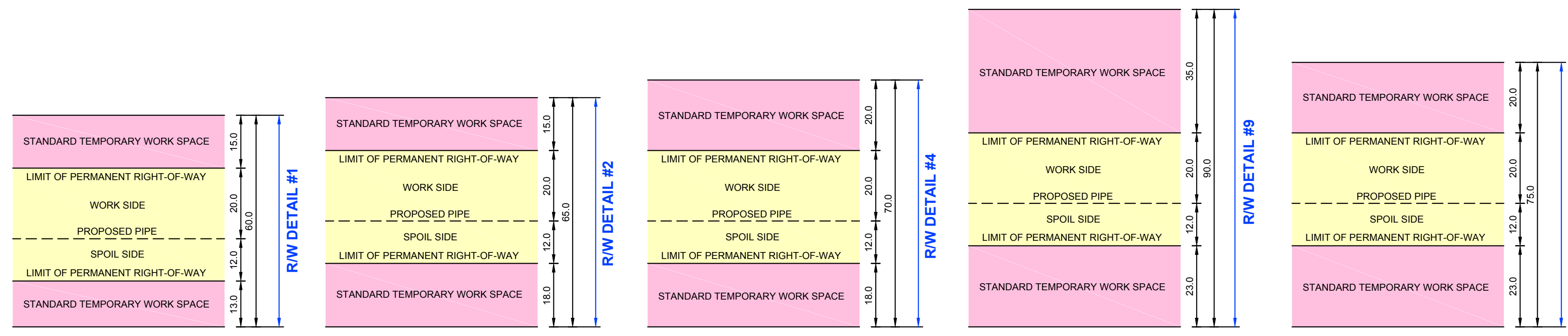

CROSSING / REFERENCE DRAWINGS				
Crossing No.	Chainage	Owner	Description	NAD 83 UTM Zone 9
1727.00-WC	579+670	CROWN	WATER CROSSING - WATERCOURSE - UNNAMED TRIBUTARY (GOSNELL CREEK) - S4° - STANTEC ID NO.: 5898	N=6005526.0, E=586934.8
1728.00-WC	579+621	CROWN	WATER CROSSING - WATERCOURSE - UNNAMED TRIBUTARY (GOSNELL CREEK) - S6° - STANTEC ID NO.: 5908	N=6005415.6, E=586832.6
1729.00-DR	580+307	CROWN	DRAW	N=6005040.1, E=586529.0
1730.00-WC	580+383	CROWN	WATER CROSSING - WATERCOURSE - UNNAMED TRIBUTARY (GOSNELL CREEK) - NON-VISIBLE DRAINAGE - STANTEC ID NO.: 591B	N=6004984.2, E=586478.5
1731.00-RD	580+710	CANADIAN FOREST PRODUCTS LTD.	ROAD - PERMITTED ROAD - R07593 6 - CP 573 - HIGH GRADE	N=6004725.8, E=586313.6
1732.00-RD	581+176	CROWN	ROAD - NON-STATUS ROAD - NON-TENURE - TRAIL	N=6004372.0, E=586052.3
1733.00-WC	581+667	CROWN	WATER CROSSING - WATERCOURSE - UNNAMED TRIBUTARY (GOSNELL CREEK) - S4° - STANTEC ID NO.: 5928	N=6004019.4, E=585713.3
1734.00-WC	581+813	CROWN	WATER CROSSING - WATERCOURSE - UNNAMED TRIBUTARY (GOSNELL CREEK) - S4° - STANTEC ID NO.: 5938	N=6003914.4, E=585612.4
1735.00-RD	582+417	CANADIAN FOREST PRODUCTS LTD.	ROAD - PERMITTED ROAD - R07593 6 - CP 573 - HIGH GRADE	N=6003896.6, E=585107.3

LEGEND:

Proposed Pipeline shown thus:

Buried Pipe shown thus:

Power Pole shown thus:

Overhead Power Line shown thus:

Buried Cable shown thus:

Buried or Overhead Phone Cable shown thus:

Existing Well Site and Access shown thus:

Existing Right-of-Way (RW) shown thus:

Crown Tenure shown thus:

Center Line of Shoofly / Potential New Road Construction shown thus:

Recreational Trail shown thus:

Non-Status Road shown thus:

MOTI, Permitted and Forest Service Road shown thus:

Numbered Highway shown thus:

Railway shown thus:

Hydrology (TRIM Data) shown thus:

Hydrology (TRIM Data) NCD/NVD shown thus:

Draws shown thus:

Wetlands shown thus:

Riparian Management Zone (RMZ) shown thus:

Riparian Reserve Zone (RRZ) shown thus:

Potential Ancillary Site shown thus:

Fence Line shown thus:

Tree / Bush Line shown thus:

Forest Cut Block / Opening shown thus:

Tree Farm Licence shown thus:

Wildlife Tree Retention shown thus:

Woodlots shown thus:

Parks and Protected Areas shown thus:

Permanent Right-of-Way (RW) shown thus:

Temporary Workspace (TWS) shown thus:

Log Deck shown thus:

Shoofly Road shown thus:

Laydown shown thus:

Log Storage Site shown thus:

Stockpile Site shown thus:

Alternate Right-of-Way (RW) shown thus:

Alternate Temporary Work Space (TWS) shown thus:

Alternate Log Deck shown thus:

Pipeline Construction Corridor shown thus:

Range Tenure shown thus:

Old Growth Management Area shown thus:

Agricultural Land Reserve (ALR) shown thus:

Ungulate Winter Range shown thus:

Mineral Claim / Lease shown thus:

Visual Sensitivity Boundary shown thus:

Wildlife Habitat shown thus:

Generic Well Symbol shown thus:

Proposed Block Valve shown thus:

Dwelling shown thus:

Pf's shown thus:

(Pf's Greater Than 14' Shown Red)

Change in Direction of Construction shown thus:

Construction Plan Match Line shown thus:

Alignment Plan Match Line shown thus:

Off Right-of-Way Crossing shown thus:

Preliminary Pipe Profile Chainage shown thus:

(Chainages shown are on ditch line.)

BCGS: 93L.012, 93L.013, 93L.014, 93L.015, 93L.016, 93L.017, 93L.018, 93L.022, 93L.023

EPASS No.: 10049409

NOTE: Water Course Crossing Information and New Cut / Existing Cut Information provided to Survey by Coastal GasLink Pipeline Ltd. for the Coastal GasLink Pipeline Project.

NOTE: Refer to Key Plan for Area Table Information.

No.	Date	Description	Drawn By	CKD By
1	OCTOBER 20, 2014	- PLAN ISSUED	K.P.J.C.	R.D./K.L.

NOTE: The information shown on this plan is obtained from various sources including the Government of British Columbia. Information from these sources may change without notice and may not reflect the status as shown on this plan. McElhanney takes no responsibility for the accuracy or completeness of this information, spatially or otherwise.

PROJECT INFORMATION:

THE PROPOSED PROJECT IS:

- To be flagged at time of construction.
- Partially within the Agricultural Land Reserve (ALR)
- Within the South West OGC Zone

NOTE:

- Co-ordinates are UTM Grid NAD 83, Zone 9N. Reference Meridian 129°
- Distances are ground and in metres and decimals thereof

NOTE: Positions of buried facilities shown are derived from interpretations of signals from electronic devices. Reception of electronic signals is subjected to interference and has limitations, therefore it should not be assumed that all buried facilities are shown, and facilities which are shown should not be construed as "located" until physically exposed. All underground installations should be marked by the respective authorities prior to excavation or construction.

British Columbia One Call: 1-800-474-6886

REVISION / ISSUED

Coastal GasLink Pipeline Project

TransCanada
In business to deliver

COASTAL GASLINK PIPELINE LTD.

CONSTRUCTION PLAN SHOWING
32.0 & 42.0 PIPELINE RIGHT OF WAY
SECTION 7

FROM
UNIT 2, BLOCK I, 93-L-2
TO
UNIT 6, BLOCK J, 93-L-4

THROUGH SURVEYED AND UNSURVEYED CROWN LAND
RANGE 5 COAST DISTRICT

SCALE - 1:5000

16442-08-ML-02-185

Sheet 21 of 21

Route Reference: RevE1

Oct 20, 2014

Document No. CGW4703-MCSL-G-MP-424-021

Rev 0

McELHANNEY
8808 - 72nd Street
Fort St. John, British Columbia
Phone: (250) 787-0356
3111-21422